

DOVER DISTRICT COUNCIL

(WALDERCHAIN WOOD, BARHAM)

ARTICLE 4 DIRECTION NO. 4 1990

TOWN AND COUNTRY PLANNING ACT 1990

TOWN AND COUNTRY PLANNING GENERAL DEVELOPMENT ORDER 1988 (AS AMENDED)

ARTICLE 4

SCHEDULE 2

~~PART 5 CLASS A~~

PART 6 CLASS A

PART 7 CLASS A

DOVER DISTRICT COUNCIL

TOWN AND COUNTRY PLANNING ACT 1990

TOWN AND COUNTRY PLANNING GENERAL DEVELOPMENT ORDER 1988 (AS AMENDED)

WHEREAS the Council of the District of Dover being the appropriate local planning authority within the meaning of Article 4 of the Town and Country Planning General Development Order 1988<sup>(As Amended)</sup> are satisfied that it is expedient that development of the descriptions set out in the Schedule hereto should not be carried out on land within the Dover District forming part of Walderchain Wood, Barham in the County of Kent and comprising 3.75 hectares or thereabouts being the area of land shown cross hatched on plan number 172/90 annexed hereto unless permission therefor is granted on application made under Part III of the Town and Country Planning Act 1990

NOW THEREFORE the said Council in pursuance of the powers conferred upon them by the said Article 4 hereby direct that the permission granted by Article 3 of the Town and Country Planning General Development Order 1988<sup>(As Amended)</sup> shall not apply to development on the said land of the descriptions set out in the Schedule hereto

THIS DIRECTION may be cited as the Dover District Council (Walderchain Wood, Barham) Article 4 Direction No. 4 1990

Given under the Common Seal of the District Council of Dover this 21st day of December One thousand nine hundred and ninety

THE COMMON SEAL of the Council )  
was hereunto affixed in the )  
presence of: )



*Lesley Cumberland*

8974

Authorised Chief Officer  
Dover District Council

## SCHEDULE

- (a) Development permitted under Article 3 and Schedule 2 Part 5 Class A of the Town and Country Planning General Development Order 1988 namely

"The use of land, other than a building, as a caravan site in the circumstances referred to in paragraph A.2."

"A.2. The circumstances mentioned in Class A are those specified in paragraphs 2 to 10 of Schedule 1 to the 1960 Act, but in relation to those mentioned in paragraph 10 do not include use for winter quarters."

- (a) (b) Development permitted under Article 3 and Schedule 2 Part 6 Class A of the Town and Country Planning General Development Order 1988 (As Amended) namely

"The carrying out on agricultural land comprised in an agricultural unit of -

- (a) works for the erection, extension or alteration of a building, or
- (b) any excavation or engineering operations, reasonably necessary for the purposes of agriculture within that unit."

*and not being development comprised within any other part*

- (b) (c) Development permitted under Article 3 and Schedule 2 Part 7 Class A of the Town and Country Planning General Development Order 1988 (As Amended) namely

"The carrying out on land used for the purposes of forestry, including afforestation, of development reasonably necessary for those purposes consisting of -

- (a) works for the erection, extension or alteration of a building;
- (b) the formation, alteration or maintenance of private ways;
- (c) operations on that land, or on land held or occupied with that land, to obtain the materials required for the formation, alteration or maintenance of such ways;
- (d) other operations (not including engineering or mining operations)."

*and not being development comprised within any other part.*

The Secretary of State for the Environment hereby approves the foregoing direction subject to the modifications shown in red ink thereon.

A handwritten signature in black ink, appearing to be 'RAN' with a horizontal line underneath.

Signed by authority  
of the Secretary of  
State

5 March 1991

A Regional  
Controller in the  
Department of the  
Environment



# ARTICLE 4 DIRECTION SITE

District Council Boundary

Area of Article 4 Direction within Canterbury City Council area

Area of Article 4 Direction within Dover District Council area

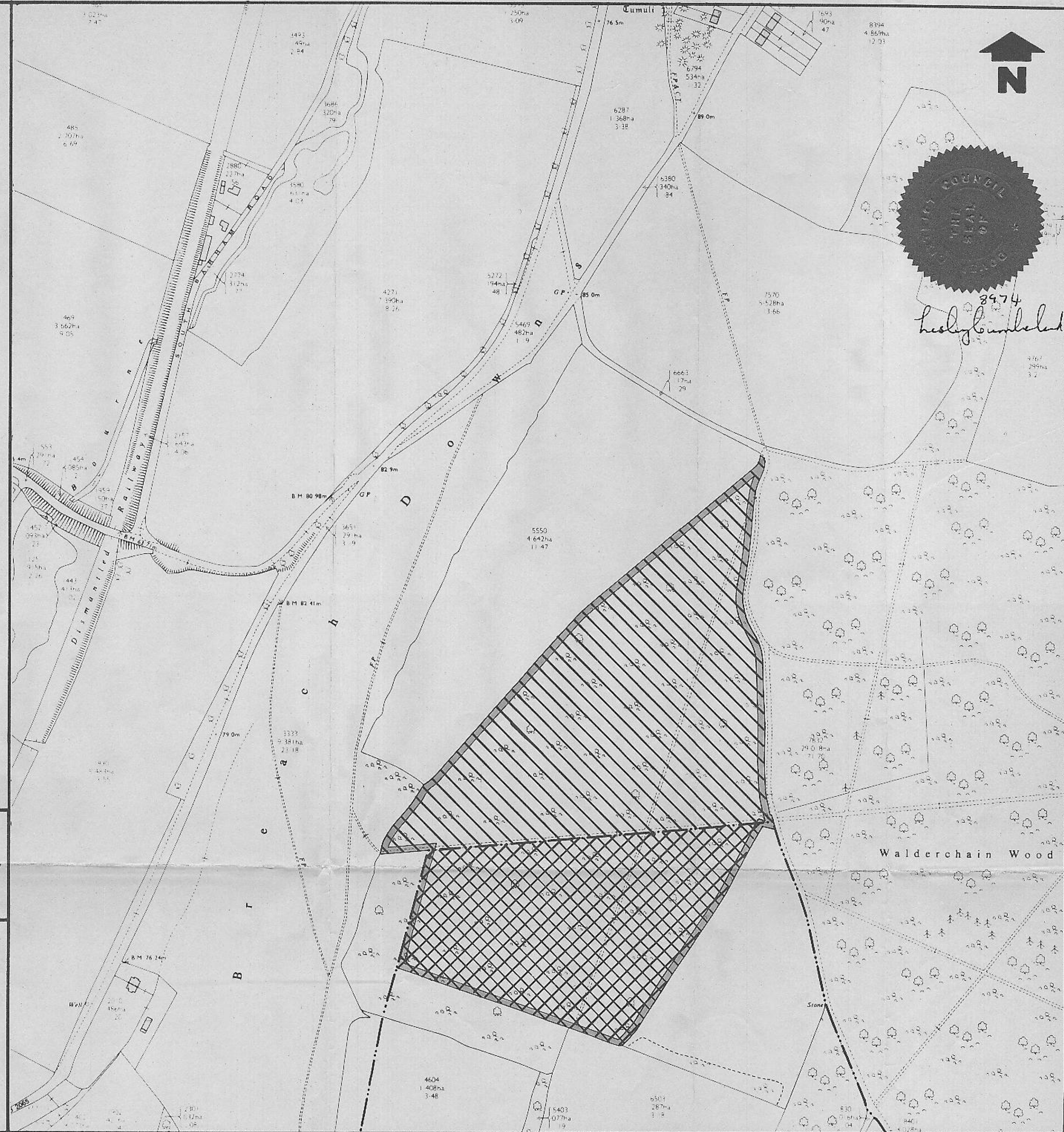
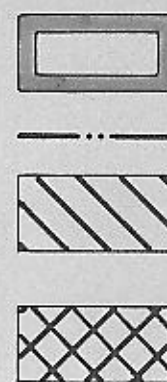

TOWN AND COUNTRY PLANNING ACT 1990  
TOWN AND COUNTRY PLANNING GENERAL DEVELOPMENT ORDER 1988  
ARTICLE 4 DIRECTION Land at Walderchain Wood, Barham Parish, City of Canterbury  
and Denton with Wootton Parish, Dover District.

**Dover District Council**

John R. Clayton B.Sc., C.Eng., Eur. Ing., F.I.C.E.  
DIRECTOR OF PLANNING AND TECHNICAL SERVICES

District Council Offices  
Honeywood Road, Whitfield, Dover, Kent. CT16 3PG  
Telephone Dover (0304) 821199

PLANNING DIVISION  
D.J. Sturt, B.A., Dip.T.P., M.R.T.P.I.  
Chief Planning Officer

Scale: 1/2500

From O.S. sheet TR 2048

Plan no. 172/90

Date: 26 October 1990

Drawn by B.B.F.

Reproduced from the Ordnance Survey Map with the sanction  
of the Controller of H.M. Stationery Office. Crown Copyright  
Reserved.