

KENT COUNTY COUNCIL

TOWN AND COUNTRY PLANNING

TOWN AND COUNTRY PLANNING GENERAL DEVELOPMENT ORDER,
1963.

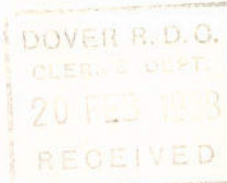

W H E R E A S

(1) the County Council of the Administrative County of Kent (hereinafter referred to as "the County Council") is the Local Planning Authority for the said County for the purposes of the Town and Country Planning Act, 1962;

(2) the County Council is satisfied that it is expedient in the interests of the amenities of the area that development of the description set out in the Schedule hereto shall not take place on land known as part O.S. 316, Poulton Farm, Hougham Without in the Rural District of Dover such land being shown coloured pink on the plan annexed hereto (hereinafter referred to as "the pink land") unless permission therefore is granted on an application in that behalf.

N O W THEREFORE the County Council in pursuance of the powers conferred upon it by Article 4 of the Town and Country Planning General Development Order 1963 and of all other powers enabling it in that behalf HEREBY DIRECTS that the permission granted by Article 3 of the said Order of 1963 shall not apply to development of the description specified in the Schedule hereto in on over or under the pink land or any part or parts thereof.

THIS DIRECTION may be cited as the Kent County Council (Rural District of Dover) Town and Country Planning Direction No. 1, 1967.

/SCHEDULE

SCHEDULE

The carrying out on agricultural land having an area of more than one acre and comprised in an agricultural unit, being the aforesaid O.S. 316, Poulton Farm, Hougham Without, of building or engineering operations requisite for the use of that land for the purposes of agriculture being development comprised within Paragraph 1 of Class VI of Part I of the First Schedule to the Town and Country Planning General Development Order 1963 and not being development comprised within any other Class

GIVEN under the Common Seal of the County Council of the Administrative County of Kent this 1st day of December one thousand nine hundred and sixty-seven.

(THE COMMON SEAL OF THE COUNTY
COUNCIL OF THE ADMINISTRATIVE
COUNTY OF KENT was hereunto
affixed in the presence of:-

(Sgd.) D. S. E. THOMPSON

L.S.

Chairman of the County Council

(Sgd.) G. T. HECKELS

Clerk of the County Council.

I hereby certify that this is a true copy.

G. T. Heckels

Clerk of the County Council

100

HLG 34795

The Minister of Housing and Local Government hereby approves the foregoing direction.

Given under the Official Seal
of the Minister of Housing
and Local Government on the
13th February, 1968.

L.S.

(Sgd.) L. Goodman

Assistant Secretary
Ministry of Housing and Local
Government

~~7424~~

DATED 1st December 1967.

KENT COUNTY COUNCIL
TOWN AND COUNTRY PLANNING

Kent County Council (Rural District of
Dover) Town and Country Planning Direction
No. 1, 1967.

KENT COUNTY COUNCIL
(Rural District of Dover)

Town and Country Planning Direction No. 1. 1967

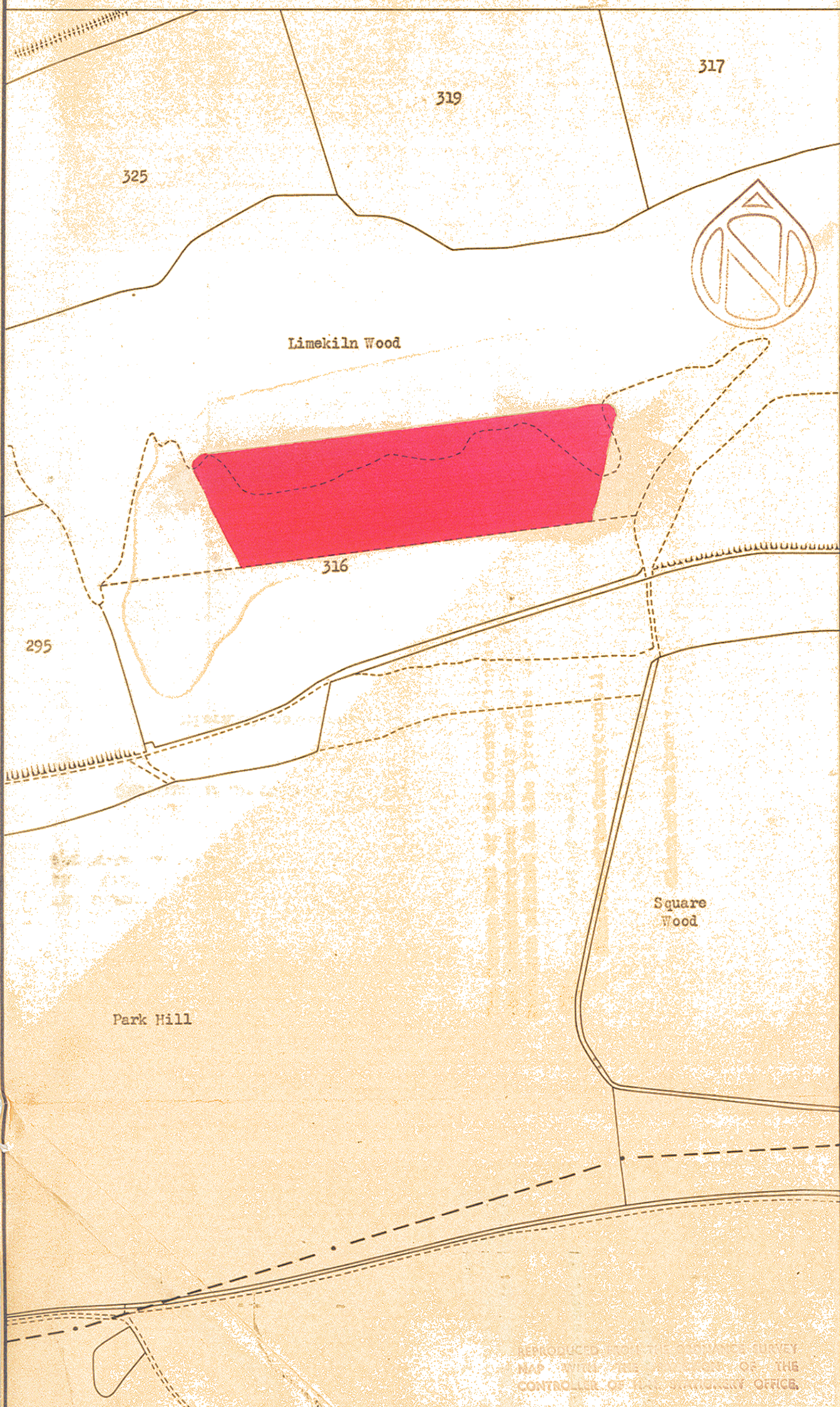

Scale: 1:2500

Date 21.11.67

O.S. Sheets 67/16

Drawn by A.V.M.
on the instructions of
A.J. Gaynor B.Sc. A.M.T.P.I.

R. G. Clarke
Chartered Town Planner
County Planning Officer

The Common Seal of the County Council of
the Administrative County of Kent was
hereunto affixed in the presence of:-

(Sgd) D S E. THOMPSON

Chairman of the County Council.

L.S.

(Sgd) G.T. HECKELS

Clerk of the County Council.