

Appendix 1:
Theme 9 – Agriculture and Farmsteads



Theme 9 – Agriculture and Farmsteads

Summary

9.1 The District's historic farmsteads have played a key role in shaping the character and local distinctiveness of the rural landscape of this part of East Kent. They make a significant and highly varied contribution to the rural building stock of the area. The District's agricultural buildings also reflect the richness of the agricultural landscape. Various agricultural industries are also represented; oasts are a visible reminder of the former hop industry, whilst the District's surviving windmills highlight the arable importance of this part of Kent.

Introduction

The agricultural landscape of Dover District

9.2 The inland areas of Dover District are predominantly agricultural in nature. The majority of the District lies on the chalk downland of the North Downs, whilst the northern parts of the District form part of the North Kent Plain, an area predominantly formed of sands and Brickearth and bounded by large areas of reclaimed marshland of the former Wantsum Sea Channel (see Theme 1).

9.3 The Downlands were traditionally areas for sheep grazing and arable (primarily corn) production. Substantial holdings are typical in such agricultural regimes, and many farms became wealthy in the post medieval period. Within the East Kent area the fields of the North Downs are typically large, having been enclosed in a piecemeal fashion. There are a number of large country estates within this

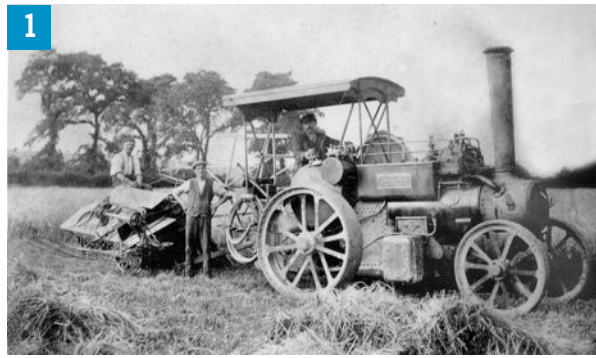

downland belt (see Theme 7.1); the settlement pattern is generally one of nucleated settlement, with small villages being intermixed with isolated farmsteads (see Theme 8).

9.4 The North Kent Plain is generally more diverse in nature, with a mix of arable production, orchard and fruit growing and sheep farming being seen. Corn production on the fertile Brickearth soils of the North Kent Plain has been important since at least the Iron Age and, together with the development of brewing and malting from the fifteenth century, has been stimulated by the ease of access to the London market. The area includes rich horticultural lands around Wingham and reclaimed marshland around Stourmouth, the Ash Levels and the Lydden Valley. Settlement is similarly varied with small market towns such as Wingham inter-mixed with nucleated and dispersed settlement. Field systems within the North Kent Plain primarily comprise either Orchards (particularly on the higher ground adjacent to the Ash Levels), or Prairie Fields relating to nineteenth century enclosure (such as in the Ash, Staple and Woodnesborough areas), or the small rectilinear fields on reclaimed marshland, some of which are a result of medieval ecclesiastical reclamation.

The farmsteads of Dover District

9.5 Historic farmsteads are assets which make a significant and highly varied contribution to the rural building stock, landscape character and local distinctiveness

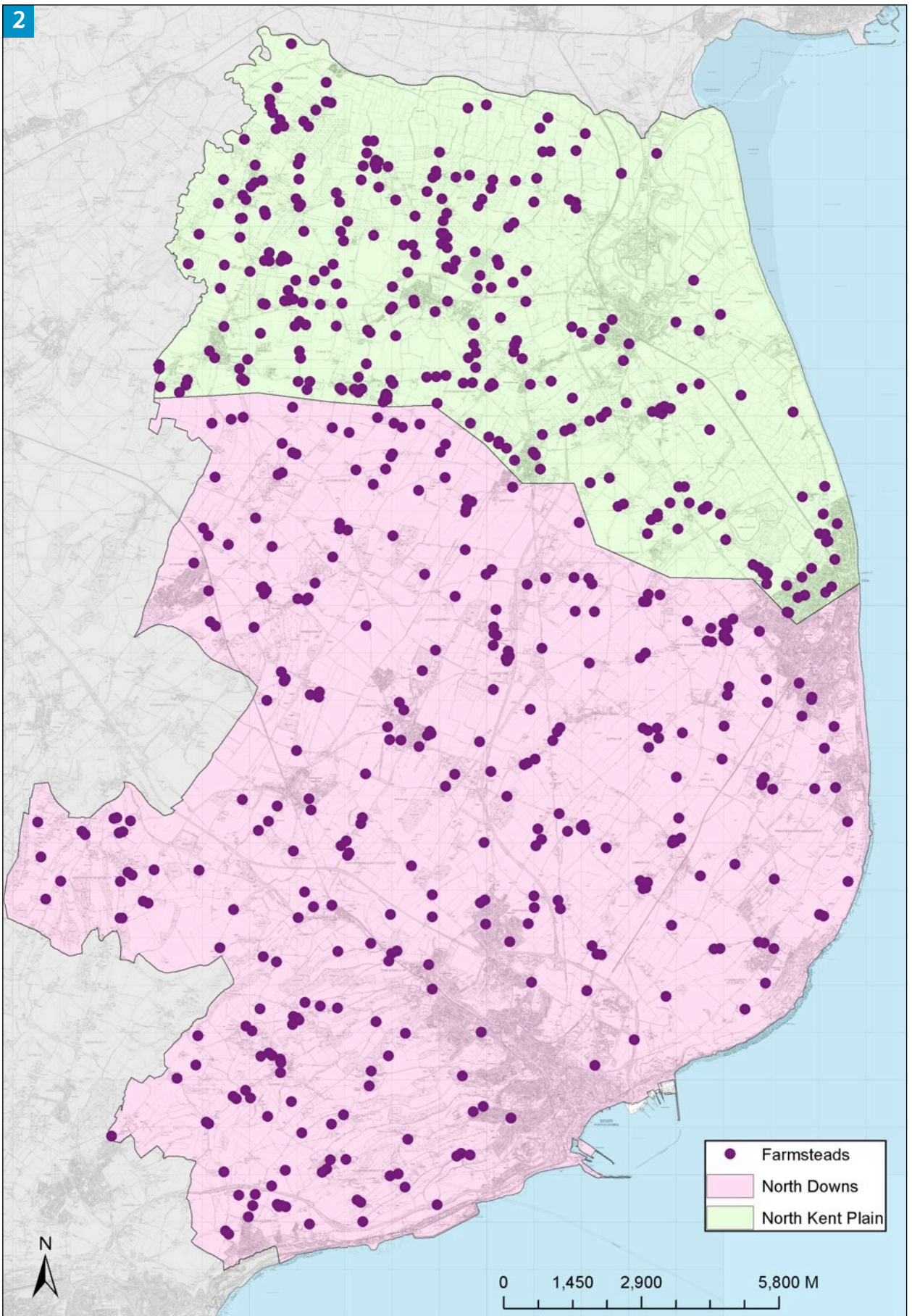

Figure 2 Distribution of Dover District's Farmsteads based on data from the Historic Farmsteads Survey

3



of the District. They are also assets which, through agricultural and other new uses, have significant potential to make an important contribution to the rural economy and communities away from market towns and other rural centres.

9.6 *The Kent Farmsteads and Landscapes Project* has identified a total of 516 farmsteads within the District. Farmsteads as described here are defined as being the primary homestead for the farm where the main farmhouse as well as various working buildings is located. There is a notable difference between the low density of farmsteads in the downland areas to the centre and south of the District (as a result of the growth of large capital-based farms and also the removal of the area's many small-scale farmsteads from agriculture in the nineteenth and twentieth centuries), and the higher density of farmsteads in the North Kent Plain to the north. X% lie in the area

that can be broadly seen as belonging to the East Kent Downland and X% lying on the North Kent Plain.

9.7 The survey also identified 96 outfarms within the District. Outfarms are defined as being an individual or isolated group of buildings set within the fields away from the main farmstead. Such outfarms were common on larger or dispersed farms and were sometimes the result of amalgamations, with the remnants of former farmstead surviving, but the farmhouse being abandoned. Outfarms are particularly vulnerable to loss as a result of modern agricultural practices.

Windmills

9.8 East Kent was a major arable producing area and at the time of the First Edition Ordnance Survey map there were numerous windmills spread across the

Figure 3 Home Farm, Knowlton (GII LB - c. 1600-1866)

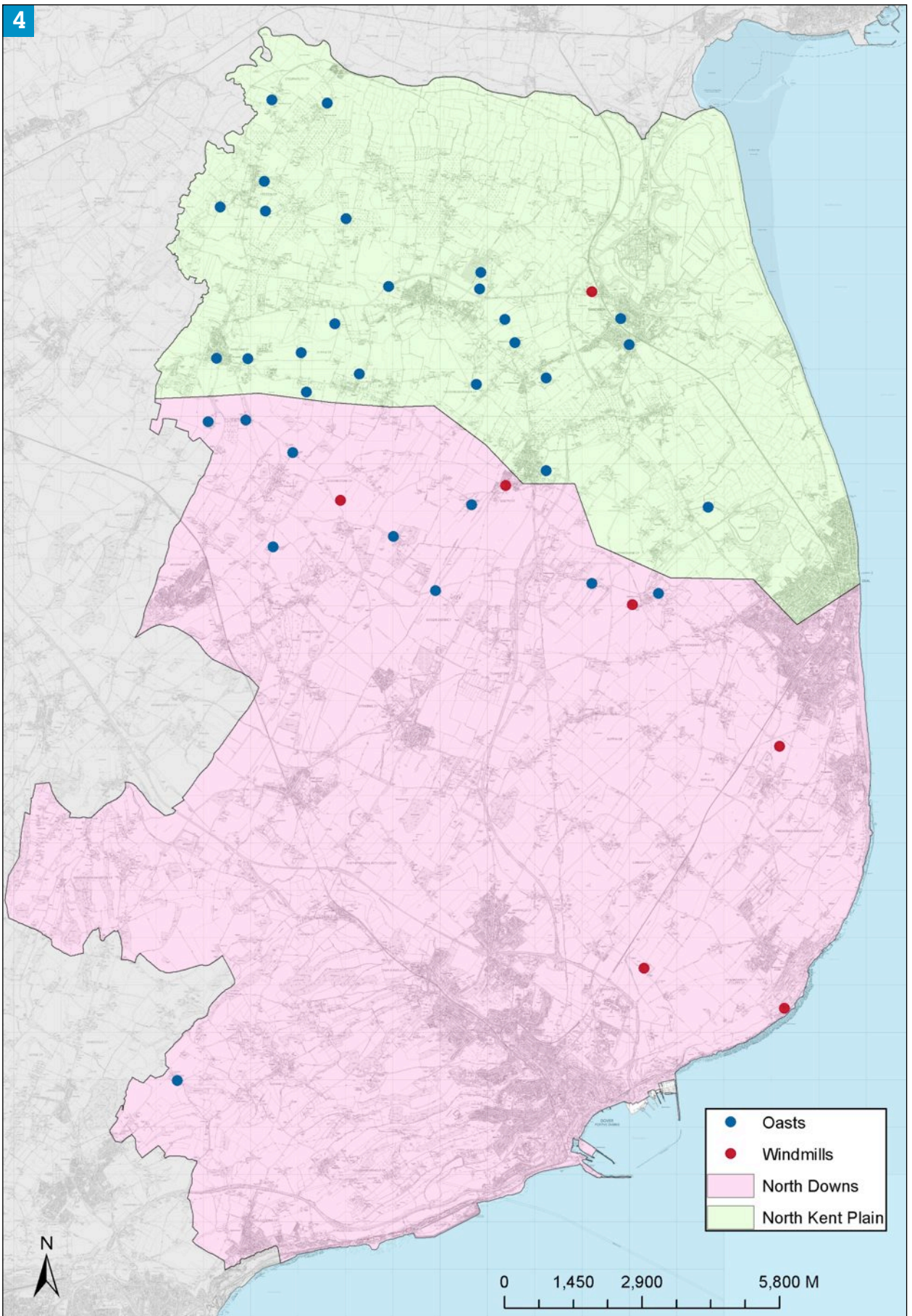

Figure 4 Distribution of Dover District's Windmills and Oasthouses recorded in the Kent Historic Environment Record

5



mill turned on a central post to face the wind. The later, more sophisticated, smock-mill (so called because it looks like a farm worker's smock) enabled just the cap with the sails to turn automatically to face the wind, while the 'smock' with its machinery inside remained static. Tower mills are similar in form to smock mills, having a fixed tower, but of brick rather than wooden construction.

Oast houses

9.9 The Kentish hop industry developed from the sixteenth century and rapidly became an important part of the agricultural landscape. By the 1650s Kent accounted for about one third of England's hop production. The traditional heartland of the Kentish hop industry has been in the west of the county,

particularly in the areas around Goudhurst and Lamberhurst. By the second half of the nineteenth century Kentish hop production had reached its peak and new areas of hop growing opened up around Faversham and Canterbury.

9.10 Dover's hop production was focussed to the north-west of the District on the fertile soils of the North Kent Plain around Preston, Staple, Wingham, Stourmouth and Ash. After the Second World War hop growing sharply declined in East Kent. Thirty-two Oast Houses (or hop-kilns), in which hops were dried, are recorded in the District in the Kent Historic Environment Record and/or by the Kent Farmsteads Survey.

Description of the Heritage Assets

Farmsteads

9.11 The Districts Farmsteads have been characterised as part of the Kent Historic Farmsteads Survey. Rather than describe individual farmsteads key patterns and trends identified by the survey are summarised here. A full list of farmsteads identified within the

6



Figure 5 Eastry Mills c1920. © B Hollingsbee (loaned to Dover Museum (d29522))
Figure 6 Farms, fields and oast near Elmstone



District in the survey is shown in Table 1 at the end of this Theme.

9.12 A key component of the farmstead is the **farmhouse**, which is commonly detached and faces away from the farmyard. Within Dover District the Historic Farmsteads Survey has identified a total of 460 surviving historic farmhouses of which 215 (47%) are Listed Buildings. These farmhouses range in date from medieval to nineteenth century date. Of the Listed examples 87 (almost 17%) of the farmhouses are pre AD 1600 in date, 52 (10%) are of seventeenth century date, 55 (nearly 11%) are of eighteenth century date and there are 21 (5%) Listed farmhouses of nineteenth century date.

9.13 In addition to the main farmhouse, farmstead complexes might include **barns, cart sheds, animal sheds and shelters, granaries, stables, oasts and miscellaneous outbuildings**. The size of barns can reflect the importance of the corn crop; stables and cartsheds provided the power and sheltered the implements for working the land on corn-producing farms; granaries stored grain for sale or seed corn; cattle yards made use of straw from the corn threshed in barns; and their associated buildings (open-fronted shelter sheds and cow houses) generated farmyard manure which was returned to fertilise the fields.

9.14 Few of the working outbuildings in the District are individually Listed. Just twenty farmsteads have a pre-1600 Listed working



building, all associated with a Listed farmhouse. These include large late fourteenth to early sixteenth century houses that relate to the emergence of a wealthy class of rentier farmers on the church estates from the fifteenth century. Twenty-nine farmsteads have a seventeenth century Listed working buildings and seventeen have an eighteenth century Listed working building. Just five sites have a nineteenth century Listed working farm building (1% compared to a county average of 3%).

9.15 The plan form of the farmstead - the way the buildings are arranged and associated with the farmhouse, routeways and yards - is the principle factor in determining the overall character of the farmstead. Within Dover District the farmhouses and their outbuildings can be largely subdivided into:

- **Courtyard plan farmsteads**, which are the predominant plan type (85% of those recorded). They have the working buildings and sometimes the farmhouse arranged around one or more yards. They subdivide into *loose courtyard plans*, which have one or more detached working farm buildings facing a yard area, *regular courtyard plans* where the working buildings around the yard are linked and planned in a more regular fashion and *L-shaped range of working plans* with additional buildings to a third or fourth side of the yard. Farmsteads with regular courtyard plans are the

Figure 7 Lower Venson Farm Tilmanstone 1907. © B Hollingsbee (loaned to Dover Museum (d39547)

Figure 8 Timber framed hay store, Knowlton

most common group representing 47% of the recorded sites against 38% for loose courtyard plan types.

- **Dispersed plans** (13%) which are the least organised in their layout, with buildings loosely arranged, sometimes clustering together or grouped along a trackway. They are a highly distinctive but vulnerable element of Kent's rural landscape, forming 25% of sites in the county as a whole. There represent an early farmstead form that has survived within Kent generally, and in the Weald particularly, to a higher degree than any other parts of England else mapped to date.
- Other plan types including **Linear type arrangements** make up the remainder of the District's farmstead stock. These are generally rare in Kent and represent only 2% of the farmsteads in the District.

9.16 In general, the character of farmsteads in the Dover District is of medium to large farmsteads, predominantly courtyard groups, often with multiple yards that reflect the need to subdivide large farmsteads into separate working zones for housing and processing corn, fattening cattle and other functions such as storing timber, hop poles and drying hops. The principal farmstead plan types are shown in Figure 9.

9.17 **Courtyard plan farmsteads** are the predominant plan type in the District and subdivide into:

a-d) *Loose Courtyard farmsteads* which have buildings loosely arranged around one (a) or more (b – 2; c – 3; d – 4) sides of a yard. They typically developed in relationship to fields that reflect a centuries-old process of gradual or piecemeal enclosure from medieval open fields, woodland, downland and heathland. The Dover District is mostly characterised by the

larger examples of this plan type, with working buildings that developed in piecemeal fashion around three sides of the yard. In Kent, the smallest of these loose courtyard plans are concentrated in the Weald.

e-j) *Regular Courtyard farmsteads* which consist of linked ranges, formally arranged around one or more yards. They are strongly associated with landscapes of reorganised or planned enclosure and subdivide into:

- L-plans (e), which are mostly found in the North Kent Plain
- U-plans (f), which are uncommon and found in some of the downland valleys
- F-, E-, T-, H- or Z-shaped plans (g and h) which are rare in Kent as well as in Dover District
- full courtyard plans where the buildings enclose all sides of the yard (i)
- and multi-yard plans (j) which are typically the largest in scale and the most common of the regular plan types in Dover District.

9.18 *L-plans* with additional detached buildings to the third or fourth sides (k on plan) which are generally large to very large in scale. These are common in Dover District, reflecting the medium - large scale of its mostly arable farms

9.19 **Dispersed plans** are concentrated in landscapes of irregular and often small-scale fields including those cleared from woodland and coastal marsh but in Kent they were also common in the arable areas including the North Downs. They subdivide into:

- l) dispersed clusters, where the working buildings are dispersed within the boundary of the steading, and which are the most common form in Dover

COURTYARD PLANS

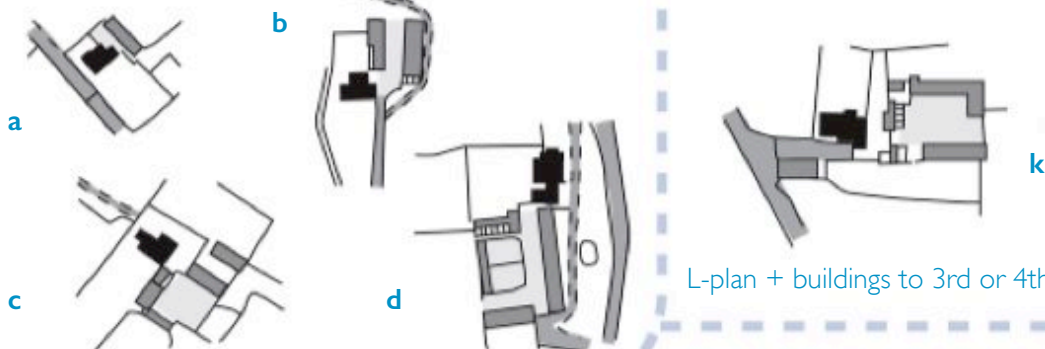

L-plan + buildings to 3rd or 4th side

Loose courtyards

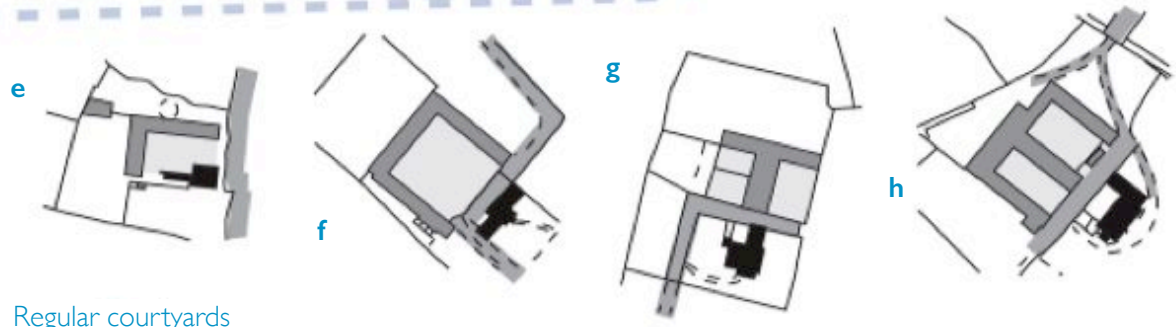

Regular courtyards

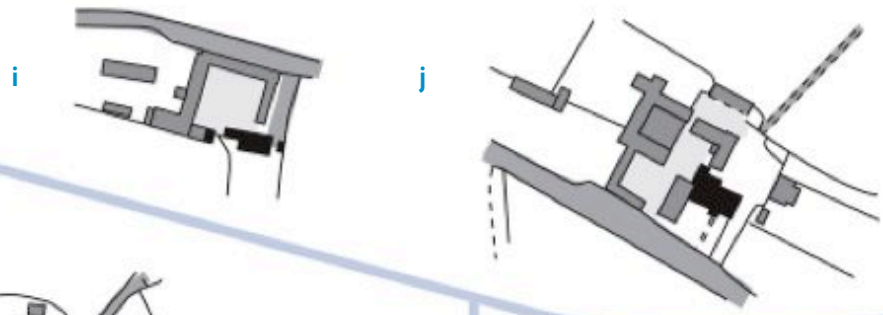

DISPERSED PLANS

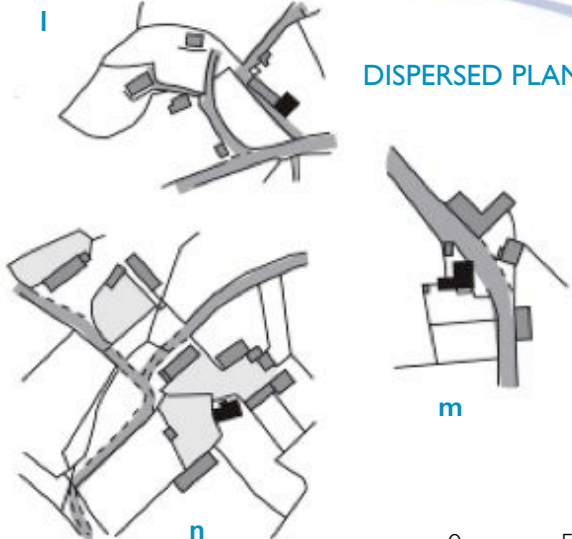

OTHER PLAN TYPES

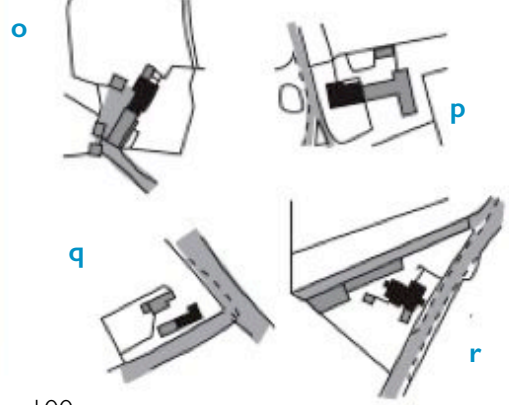

0 50 100m

Figure 9 Typical farmstead plan types (from Kent Farmsteads Guidance)

District.

- m) dispersed driftways, mostly concentrated in the Weald of Kent, which are dominated by the routeways for moving livestock and produce passing through them. There are no examples in Dover District.
- n) dispersed multi-yards, which are large-scale farmsteads containing two or more detached yards, often with other scattered buildings.

9.20 The other plan types are rare in Kent and comprise:

- o) **linear farmsteads**, where the houses and working buildings are attached and in-line, or have been extended or planned with additional working buildings to make an L-shaped range (p). They are concentrated on the small plots that developed within settlements and in areas of small-fields fields especially within or on the edges of the small fragments of remaining heathland.
- q) **parallel plans** where the working buildings are placed opposite and parallel to the house and attached working buildings with a narrow area between. They have often developed from linear farmsteads
- r) **row plans**, often medium as well as small in scale, where the working buildings are attached in-line and form a long row.

9.21 The most common traditional farm buildings encountered on farmsteads are:

- **Barns** for the dry storage and processing of the harvested corn crop, and for housing straw after threshing before it was distributed as bedding for animals and trodden into manure to be returned to the fields. In Kent they

include many high status medieval examples and aisled barns dating up to the early nineteenth century are concentrated in the corn-growing areas of east Kent and in the coastal fringe. Some very large barns were built on manorial steadings close to churches, often called a Court Farm. Multi-functional barns for housing animals and their fodder are most commonly found in the Weald, and will be very rare if found in the Dover District.

- **Granaries and cart sheds**, which are a particularly distinctive feature in corn-growing areas. Once threshed, grain needed to be stored away from damp and vermin. It would be sold off the farm or retained for animal feed. Most granaries are of late eighteenth and nineteenth century date, the need for more storage for grain often coinciding with the necessity for more cart and implement space at a time when commercial farming and markets were expanding and more implements introduced on farms. The construction of detached granaries raised off the ground on staddle stones, along with the heightening of plinth walls to timber-framed barns, was also a reaction to the threat posed by the rapid spread of the brown rat from the early eighteenth century.
- **Stables.** The largest stables are concentrated in corn-producing areas, where farms were larger and more horses were needed for ploughing and many other tasks.
- Buildings associated with the **hop industry**, oasts in which hops were dried and stored being the most prominent.
- **Yards, shelter sheds and cow houses** for housing cattle are mostly of

nineteenth century date, and may be found added to an earlier barn or detached and associated with individual yard areas. Open-fronted shelter sheds are the most common form of cattle housing found.

Outfarms

9.22 Outfarm buildings within the district are relatively rare, with some 73% of such sites having been lost from the District's landscape since the First Edition Ordnance Survey Map. Surviving outfarm buildings include **field barns** and **sheep pens**. A full list of outfarms identified within the District in the Kent Farmsteads Survey is shown in Table 2 at the end of this Theme.

Windmills

9.23 **Chillenden Windmill** is the only post mill surviving in the District. It is significant in being the last post mill to be built in the county, being constructed in 1868, and is the last surviving mill of this type surviving in Kent. Chillenden Windmill is Grade II* Listed and is maintained by Kent County Council.

9.24 There are four smock mills in the District which survive in a complete or near complete state. **Eastry Mill** (dated to 1770) is polygonal in plan and weather boarded; it is missing its sails. **Ripple Windmill** is also of late eighteenth century date. The mill was originally located at Hawkinge but was re-erected at Ripple in 1807; the mill has been fitted with replacement sails and cap. The



Figure 10 Chillenden Mill. © Explore Kent
Figure 11 The White Mill, Sandwich

New Mill at Northbourne is recorded as being built in 1848 by Holmans of Canterbury. The mill is missing its sweeps. **The White Mill** at Sandwich is probably the most complete of the District's smock mills. The mill was built in the 1760s and retains its sweeps as well as some of its original machinery. The mill is now operated as a local heritage centre and the associated miller's cottage has also been preserved. All of the District's smock mills are Grade II Listed.

9.25 **Swingate Mill** at Guston is an example of a surviving tower mill, a type that is rare across Kent. The body of the mill is built from tarred bricks, the mill's wooden cap and sweeps are missing however. The mill was built in 1849 and ceased production between the First and Second World Wars. The mill is a Grade II Listed Building.

9.26 The District's final surviving historic windmill is unusual, having not been constructed as an agricultural corn mill. **The Windmill** at South Foreland was instead built



in 1929 for Sir William Beardswell to provide electricity for his adjacent house which was constructed at the same time. The mill was constructed by Holman Brothers of Canterbury who constructed corn mills in the District (including the surviving mill at Northbourne). The mill at South Foreland was the last “traditional” mill to be built in Kent and is a smock mill in form, octagonal in plan and clad in weather boarding.

Oast houses

9.27 The vast majority of the District’s oast houses are located to the north of the District. A single oast house is recorded in the far south-west of the District at Great Everden Farm. The decline of the Kentish hop industry in the twentieth century has led to the loss of a number of buildings associated with hop production. Alongside Oast Houses hop gardens would have features **hop pickers huts, cookhouses, and tar tanks**. None of these ancillary buildings are known to survive in the District. Whilst many of the District’s **oast houses** have been demolished others have been retained, often converted into domestic accommodation. Seven of the District’s oast houses are designated as Listed Buildings, all at Grade II.

Statement of Significance

9.28 Significant traditional farmsteads, as they developed up to around 1900, will make a positive contribution to local character and distinctiveness. They do this through their varied forms, use of materials and the way that they relate to the surrounding landscape and settlement. Whether designated as heritage assets or not they will have one or more of the following:

1. Groups of historic buildings that contribute to the landscapes and settlements within which they developed.



2. Groups of historic buildings where the buildings can be seen and appreciated in relationship to each other and the yards and other open spaces within and around the farmstead.
3. Individual historic buildings with minimal change to their traditional form.
4. Locally distinctive building materials.

9.29 Farmsteads and farmstead buildings dating from 1900 to 1940 are far less likely to be representative of the character of their area.

9.30 *All substantially complete traditional farmsteads are considered to be of moderate significance*

9.31 Substantially complete traditional farmsteads are those that have retained more than half of their traditional buildings and historic footprint from the Ordnance Survey 2nd edition maps of c.1890–1900. They are less common in Dover District than in other parts of England. The *Kent Farmsteads and Landscapes Project* has mapped 6,520 historic farmsteads and 1,920 outfarms (including field barns) across Kent. Recording the extent of change since c.1900 in shows that:

- 5.4% of farmsteads (28) survive in the District with little or no change since the late nineteenth century (county average 10.3%).

Figure 12 Agricultural barn, Kownlton (GII LB - c1500-1738) - part of a group of historic farm buildings

KENT FARMSTEADS GUIDANCE

AN INTRODUCTION AND SUMMARY



- 33.1% have been subject to less than 50% loss (county average 36.1%)
- 30% have been subject to more than 50% loss (county average 24.8%)
- 11.6% of farmsteads have lost all their historic buildings (county average 12.4%)

9.32 Outfarms and field barns have been subject to much greater levels of loss. Almost 73% of these sites have been totally lost from the landscape. Only 19.8% of outfarms, field barns and sheep pens survive in the two categories of least change.

Farmsteads of outstanding significance

9.33 Determining whether the whole group or any individual buildings may have a higher level of significance can be more difficult. The following are of particular significance in a county and national context:

- Farmsteads within or next to the earthworks remaining from medieval and earlier cultivation and land use, and the archaeological remains of shrunken or deserted settlements and field systems.
- Farmsteads that have a clear visual and/or historic relationship to historic parks and gardens.
- Farmstead groups with eighteenth century or earlier working buildings, buildings other than barns being

particularly rare.

- Large-scale courtyard groups with ranges of buildings representative of arable-based agriculture are highly significant.
- Dispersed cluster and multi-yard plan farmsteads that have been subject to low levels of change are rare and significant.
- Planned farmstead groups designed in a coherent architectural style.

9.34 *Farmstead Buildings*

- Eighteenth century and earlier working farm buildings other than barns – especially those with stables, granaries and cartsheds typical of arable-based agriculture are exceptionally rare.
- Aisled barns are a highly distinctive building type, and they comprise part of a major concentration of aisled barns in south-eastern England that extends into neighbouring parts of Europe. Some may retain evidence for internal subdivision of barns into animal housing and other purposes such as granaries.
- Unconverted oasts retaining internal fittings and farmsteads retaining a range of structures associated with the hop industry are very rare and significant.
- Groups of buildings relating to the hop industry – oasts, sometimes evidence for early kilns in other working buildings and hop pickers' huts.

9.35 *Materials and Detail*

- Thatch and eighteenth century or earlier brick are rare.
- There are also some very rare surviving examples of butted boarding, of pre-

Figure 13 The Kent Farmsteads Guidance document aims to inform and achieve the sustainable development of farmsteads, including their conservation and enhancement. It includes criteria for assessing the significance of historic farmsteads

nineteenth century date. These are found inside barns, on former external walls.

- Stalls and other interior features (e.g. mangers, hay racks) in stables and cattle housing of proven nineteenth century or earlier date are very rare in Kent.

9.36 Illustrated guidance for the above can be found in the relevant parts of the *Kent Farmsteads Character Statements*.

Evidential Value

9.37 The historic farmsteads have the potential to provide important evidence for the layout, organisation and development of Kentish agriculture over time. Buried archaeological remains at such historic farmsteads may provide evidence for earlier iterations. A number of the District's farmsteads are located on the site of former courts or manors mentioned by Edward Hasted, which in turn often develop from medieval manors mentioned in the Domesday survey and some may have earlier origins in the Anglo-Saxon period. As such the District's farmsteads may contain buried archaeological evidence that could illustrate the earlier histories of the sites from the early medieval period onwards. The buildings themselves have often been modified and extended over the centuries and detailed examination of the fabric of these buildings may reveal evidence for their earlier incarnations. It is also possible that the core of some of the District's farmhouses (or their out-buildings) could include evidence for much earlier elements that have been incorporated into later re-buildings.

Historical Value

9.38 Historic farmsteads contribute to local character and distinctiveness through their varied use of materials and the way that buildings of different dates and types, yards and open spaces relate to each other and the

14



surrounding landscape and settlement. All these reflect local variations in the size and functions of farmsteads, which were to house the farming family and any workers, store and process the harvested corn crop, fruit and hops, house farm animals, vehicles and implements and return farmyard manure to fertilise surrounding fields. Historic farmsteads also reflect the local geology, and differences in building traditions and wealth, estate policy, access to transport links and the management of local timber and other resources. Historic farmsteads and their buildings hand down messages from our past – to this and to succeeding generations – they are illustrative of how our ancestors farmed and lived, thought and built.

Aesthetic Value

9.39 Historic farmsteads and their buildings are irreplaceable repositories of local crafts, skills and techniques, in harmony with their surroundings and using traditional materials, often closely related to the local geology, that are sometimes not available or too expensive for new building projects. They may also provide important wildlife habitats.

Communal Value

9.40 Historic farmsteads are an essential contributor to local character, beauty and distinctiveness in the countryside and to the sense-of-place enjoyed by rural communities and visitors alike. They are also assets which, through agricultural and other new uses, have significant potential to make an important contribution to the rural economy and

Figure 14 *St Radegund's Abbey Barn. Analysis of the building suggests it may originally have been the great Guesthouse of the Premonstratensian Abbey of St. Radegund's*

15



communities away from market towns and other rural centres.

Vulnerabilities

9.41 The District's traditional working farm buildings are under great pressure from change, particularly from the industrialisation of farming practices and changes in farming regimes. These new practices may lead to disuse of traditional buildings and development pressures from the construction of new warehousing, barns or livestock shelters. New development at working farms can not only impact the setting and significance of individual historic farm buildings, but can alter the traditional plan-form of the farmstead that is often a key component of the farmstead's character.

9.42 Intensification of farming methods, larger scale activities (and machinery) along with diversification can all lead to changes in requirements at farms and traditional farm buildings are vulnerable to falling into redundancy and disrepair. If alternative uses cannot be found for these working buildings

Figure 15 The converted mill at Eastry has lost its sails

16



they are vulnerable to decay and deterioration in their fabric. Where buildings have not been abandoned, but have been retained for lower grade uses they are often maintained to a lower standard, with non-sympathetic or low quality 'patched repairs' being made.

9.43 Where historic farm buildings are converted, be that for alternative agricultural, enterprise or residential uses, they are vulnerable to poor quality conversion works that are not sympathetic to the character of the place. This is especially the case for those rural agricultural buildings that are not Listed and which do not fall within a Conservation Area, but which are clearly of local historic interest.

Opportunities

9.44 Traditional farm buildings make an essential contribution to the character of the rural landscape of Dover District. This contribution is often undervalued, especially where the buildings remain in use as an active working farm. Opportunities should be sought to enhance and protect the historic farm buildings of Dover District. Where an economic use cannot be found for traditional farm buildings as part of a working farm, then opportunities should be sought to find new sustainable uses for such buildings.

9.45 Sensitive re-use of historic farm buildings can alleviate the pressures on new development in rural areas. Re-using historic buildings rather than building anew can help

Figure 16 Chillenden Mill collapsed during a storm, but has subsequently been restored

17



to maintain the historic character of a place. Re-using existing buildings is a simple way of achieving sustainability whilst bringing the added benefit of reinforcing the sense of place that they engender. Re-use of existing buildings can also be economically beneficial, with historic buildings often being considered more desirable and thus carrying a premium. As such historic farm buildings can provide an important economic asset for farms and the rural economy. Where conversion work is required this should be sensitive to and retain the historic character of the site. Conversion should, where possible, use traditional materials and techniques; any new additions should be in keeping with the existing character. Using local and traditional methods

in conversion works also has the added benefit of maintaining traditional local skills and construction techniques that might otherwise be lost.

9.46 Opportunities should be sought to protect and conserve the District's historic farm buildings. This might be through formal designation or through inclusion on a local list. The Kent Farmsteads Guidance paper provides advice and recommendations for identifying significance and managing change at historic farmsteads. It is recommended that the guidance provided within this document is used to inform any proposals for change to the District's historic farmsteads.

Sources Used & Additional Information

English Heritage & Countryside Agency, 2006: *Living buildings in a living landscape: finding a future for traditional farm buildings*. London: English Heritage & Countryside Agency.

Lake, J., Webb, J. & Edwards, B., 2011: *Kent Farmsteads Guidance (Consultation Draft March 2011)*. Maidstone: Kent County Council.

Lawson, T. & Killingray, D. (eds.), 2004: *An Historical Atlas of Kent*. Chichester: Phillimore.

The National Heritage List for England available at <http://list.english-heritage.org.uk>

English Heritage Historic Farm Buildings Guidance available at www.helm.org.uk/farmbuildings

Figure 17 A converted oast in the village of Preston

Name	Parish	Position	Form	Date	Condition
Moat Farm	Ash	Isolated	Dispersed	Pre 1600	Extent (no apparent alteration)
Malmains Manor	Alkham	Village	Dispersed	Pre 1600	Extent (no apparent alteration)
Richborough Farm	Ash	Farmstead Cluster	Loose Courtyard	Pre 1600	Extent (no apparent alteration)
Coldred Court Farm	Shepherdswell with Coldred	Church, Manor or other high status farmstead	Loose Courtyard	Pre 1600	Extent (no apparent alteration)
Paddleduck Farm (Puddle Duck Farm)	Stourmouth	Village	Regular Courtyard	Pre 1600	Extent (no apparent alteration)
Shatterling Farm	Staple	Isolated	Regular Courtyard	Pre 1600	Extent (no apparent alteration)
Little Twitham Farm	Goodnestone	Isolated	Loose Courtyard	Seventeenth Century	Extent (no apparent alteration)
Reed Cottage	Staple	Isolated	Row	Seventeenth Century	Extent (no apparent alteration)
Lower Paramour Farm	Ash	Isolated	Dispersed	Nineteenth Century	Extent (no apparent alteration)
Buckland Farm	Woodnesborough	Isolated	Dispersed	Nineteenth Century	Extent (no apparent alteration)
Minnis Farm	Alkham	Isolated	Dispersed	Nineteenth Century	Extent (no apparent alteration)
Farmstead SW of Capel Street	Capel-le-Ferne	Isolated	Dispersed	Nineteenth Century	Extent (no apparent alteration)
Rookery Farm	Staple	Isolated	Loose Courtyard	Nineteenth Century	Extent (no apparent alteration)
Swallows Brook Farm	Ash	Hamlet	Loose Courtyard	Nineteenth Century	Extent (no apparent alteration)
Sweech Farm	Preston	Isolated	Loose Courtyard	Nineteenth Century	Extent (no apparent alteration)

Table 1 Farmsteads in Dover District identified by the Kent Farmsteads Survey

Name	Parish	Position	Form	Date	Condition
Barnside Lodge Farm (Little Walmestone Farm)	Preston	Farmstead Cluster	Loose Courtyard	Nineteenth Century	Extent (no apparent alteration)
Pott's Farm	Ash	Isolated	Loose Courtyard	Nineteenth Century	Extent (no apparent alteration)
Little Mongeham House	Sutton	Hamlet	Loose Courtyard	Nineteenth Century	Extent (no apparent alteration)
Sandfield Farm	Deal	Isolated	Loose Courtyard	Nineteenth Century	Extent (no apparent alteration)
Pastoral Farm	Denton with Wootton	Isolated	Loose Courtyard	Nineteenth Century	Extent (no apparent alteration)
Ale Farm	Sutton	Village	Loose Courtyard	Nineteenth Century	Extent (no apparent alteration)
Little Tickenhurst Farm	Goodnestone	Isolated	Regular Courtyard	Nineteenth Century	Extent (no apparent alteration)
Hurst Farm	Capel-le-Ferne	Hamlet	Regular Courtyard	Nineteenth Century	Extent (no apparent alteration)
Martin Vale Farm	Langdon	Isolated	Regular Courtyard	Nineteenth Century	Extent (no apparent alteration)
Farmstead of Hawkshill Farm	Walmer	Isolated	Regular Courtyard	Nineteenth Century	Extent (no apparent alteration)
Little Hougham Court	Hougham Without	Isolated	Regular Courtyard	Nineteenth Century	Extent (no apparent alteration)
Upper Farm	Sutton	Village	Regular Courtyard	Nineteenth Century	Extent (no apparent alteration)
Twitham Farm	Wingham	Isolated	Regular Courtyard	Uncertain	Extent (no apparent alteration)
White House Farm	Nonington	Village	Dispersed	Pre 1600	Partial loss (less than 50% change)
Brook House	Alkham	Village	Dispersed	Pre 1600	Partial loss (less than 50% change)

Name	Parish	Position	Form	Date	Condition
Maydensole Farm	Sutton	Isolated	Dispersed	Pre 1600	Partial loss (less than 50% change)
Wingham Well Farm (Winghamwell Farm)	Wingham	Isolated	Loose Courtyard	Pre 1600	Partial loss (less than 50% change)
Carpenter's Farm	Preston	Isolated	Loose Courtyard	Pre 1600	Partial loss (less than 50% change)
Parsonage Farm	Preston	Village	Loose Courtyard	Pre 1600	Partial loss (less than 50% change)
Farthingales	Nonington	Village	Loose Courtyard	Pre 1600	Partial loss (less than 50% change)
Barn Cottage	Nonington	Village	Loose Courtyard	Pre 1600	Partial loss (less than 50% change)
Frogham Farm (Broadsole Farm)	Nonington	Village	Loose Courtyard	Pre 1600	Partial loss (less than 50% change)
Chillenden Farm	Goodnestone	Village	Loose Courtyard	Pre 1600	Partial loss (less than 50% change)
Yard N of the Black Pig Inn	Staple	Village	Loose Courtyard	Pre 1600	Partial loss (less than 50% change)
North Court	Tilmanstone	Isolated	Loose Courtyard	Pre 1600	Partial loss (less than 50% change)
Vine Farm	Woodnesborough	Village	Loose Courtyard	Pre 1600	Partial loss (less than 50% change)
Goss Hall	Ash	Isolated	Loose Courtyard	Pre 1600	Partial loss (less than 50% change)
Redoury Cottage	Great Mongeham	Village	Loose Courtyard	Pre 1600	Partial loss (less than 50% change)
Diamond Farm	Shepherdswell with Coldred	Hamlet	Loose Courtyard	Pre 1600	Partial loss (less than 50% change)
Upton Court Farm	Shepherdswell with Coldred	Village	Loose Courtyard	Pre 1600	Partial loss (less than 50% change)

Name	Parish	Position	Form	Date	Condition
St Radegund's Abbey Farm (Radigund's Abbey Farm)	Hougham Without	Isolated	Loose Courtyard	Pre 1600	Partial loss (less than 50% change)
Newsale Farm	Shepherdswell with Coldred	Isolated	Loose Courtyard	Pre 1600	Partial loss (less than 50% change)
Eythorne Court	Eythorne	Isolated	Loose Courtyard	Pre 1600	Partial loss (less than 50% change)
Selson Farm	Eastry	Isolated	Loose Courtyard	Pre 1600	Partial loss (less than 50% change)
Uffington Farm	Goodnestone	Isolated	Regular Courtyard	Pre 1600	Partial loss (less than 50% change)
Walmestone Court Farm	Preston	Farmstead Cluster	Regular Courtyard	Pre 1600	Partial loss (less than 50% change)
Stonehall Farm	Stourmouth	Village	Regular Courtyard	Pre 1600	Partial loss (less than 50% change)
Wingham Barton Manor	Ash	Isolated	Regular Courtyard	Pre 1600	Partial loss (less than 50% change)
The Shrubbery	Worth	Village	Regular Courtyard	Pre 1600	Partial loss (less than 50% change)
Deane Farm	Wingham	Isolated	Regular Courtyard	Pre 1600	Partial loss (less than 50% change)
Home Farm	Nonington	Parkland	Regular Courtyard	Pre 1600	Partial loss (less than 50% change)
Great Pedding Farm	Staple	Isolated	Regular Courtyard	Pre 1600	Partial loss (less than 50% change)
Crixhall Farm	Staple	Isolated	Regular Courtyard	Pre 1600	Partial loss (less than 50% change)
Upper Rowling Farm	Goodnestone	Isolated	Regular Courtyard	Pre 1600	Partial loss (less than 50% change)
Chequer Court	Ash	Isolated	Regular Courtyard	Pre 1600	Partial loss (less than 50% change)

Name	Parish	Position	Form	Date	Condition
Knowlton Court Farm	Goodnestone	Hamlet	Regular Courtyard	Pre 1600	Partial loss (less than 50% change)
Hay Farm	Eastry	Isolated	Regular Courtyard	Pre 1600	Partial loss (less than 50% change)
Malmains Farm	Tilmanstone	Isolated	Regular Courtyard	Pre 1600	Partial loss (less than 50% change)
Langdon Court Farm	Langdon	Farmstead Cluster	Regular Courtyard	Pre 1600	Partial loss (less than 50% change)
Jossen Block Farm (Jossingblock Farm)	Langdon	Farmstead Cluster	Regular Courtyard	Pre 1600	Partial loss (less than 50% change)
Langdon Abbey	Langdon	Parkland	Regular Courtyard	Pre 1600	Partial loss (less than 50% change)
Solton Manor Farm	Langdon	Isolated	Regular Courtyard	Pre 1600	Partial loss (less than 50% change)
East Side Farm	Langdon	Farmstead Cluster	Dispersed	Seventeenth Century	Partial loss (less than 50% change)
King's End Farm (King's Head Farm)	Ash	Farmstead Cluster	Loose Courtyard	Seventeenth Century	Partial loss (less than 50% change)
Wenderton Farm (Little Wenderton Farm)	Wingham	Isolated	Loose Courtyard	Seventeenth Century	Partial loss (less than 50% change)
Luckett Farm	Preston	Village	Loose Courtyard	Seventeenth Century	Partial loss (less than 50% change)
Brook Farm	Wingham	Isolated	Loose Courtyard	Seventeenth Century	Partial loss (less than 50% change)
Rowling Court	Goodnestone	Isolated	Loose Courtyard	Seventeenth Century	Partial loss (less than 50% change)
Prospect Farm	Ash	Village	Loose Courtyard	Seventeenth Century	Partial loss (less than 50% change)
Denne Court Farm	Woodnesborough	Isolated	Loose Courtyard	Seventeenth Century	Partial loss (less than 50% change)

Name	Parish	Position	Form	Date	Condition
Great Selson	Eastry	Isolated	Loose Courtyard	Seventeenth Century	Partial loss (less than 50% change)
East Street Farm	Ash	Hamlet	Loose Courtyard	Seventeenth Century	Partial loss (less than 50% change)
Winkland Oaks Farm (Winklandoaks Farm)	Ripple	Isolated	Loose Courtyard	Seventeenth Century	Partial loss (less than 50% change)
Ripple Court Farm	Ripple	Isolated	Loose Courtyard	Seventeenth Century	Partial loss (less than 50% change)
Trapham Farm	Wingham	Isolated	Regular Courtyard	Seventeenth Century	Partial loss (less than 50% change)
Home Farm (Little Betteshanger)	Northbourne	Isolated	Regular Courtyard	Seventeenth Century	Partial loss (less than 50% change)
Townsend Farm	St Margaret's at Cliffe	Village	Regular Courtyard	Seventeenth Century	Partial loss (less than 50% change)
Holt Street Farm	Nonington	Isolated	Regular Courtyard	Seventeenth Century	Partial loss (less than 50% change)
Staple Farm	Staple	Village	Regular Courtyard	Seventeenth Century	Partial loss (less than 50% change)
Great Tickenhurst Farm	Goodnestone	Isolated	Regular Courtyard	Seventeenth Century	Partial loss (less than 50% change)
Updown Farm	Northbourne	Isolated	Regular Courtyard	Seventeenth Century	Partial loss (less than 50% change)
Barton Farm	Worth	Village	Regular Courtyard	Seventeenth Century	Partial loss (less than 50% change)
Finglesham Farm	Northbourne	Isolated	Regular Courtyard	Seventeenth Century	Partial loss (less than 50% change)
Northbourne Court	Northbourne	Parkland	Regular Courtyard	Seventeenth Century	Partial loss (less than 50% change)
Great Mongeham Farm	Great Mongeham	Isolated	Regular Courtyard	Seventeenth Century	Partial loss (less than 50% change)

Name	Parish	Position	Form	Date	Condition
Church Farm	Langdon	Farmstead Cluster	Regular Courtyard	Seventeenth Century	Partial loss (less than 50% change)
Deerson Farm	Preston	Isolated	Loose Courtyard	Eighteenth Century	Partial loss (less than 50% change)
Dean Farm	Stourmouth	Village	Loose Courtyard	Eighteenth Century	Partial loss (less than 50% change)
Barfrestone Court	Eythorne	Village	Loose Courtyard	Eighteenth Century	Partial loss (less than 50% change)
Hammill Farm	Woodnesborough	Hamlet	Loose Courtyard	Eighteenth Century	Partial loss (less than 50% change)
Shingleton Farm	Eastry	Isolated	Loose Courtyard	Eighteenth Century	Partial loss (less than 50% change)
Mulberry House (Fleet Farm)	Ash	Isolated	Loose Courtyard	Eighteenth Century	Partial loss (less than 50% change)
Ivy House	Great Mongeham	Village	Loose Courtyard	Eighteenth Century	Partial loss (less than 50% change)
Hull Place (Hull House)	Sholden	Village	Loose Courtyard	Eighteenth Century	Partial loss (less than 50% change)
Elvington Court	Eythorne	Isolated	Loose Courtyard	Eighteenth Century	Partial loss (less than 50% change)
Singledge Farm	Whitfield	Isolated	Loose Courtyard	Eighteenth Century	Partial loss (less than 50% change)
Temple Farm	Whitfield	Isolated	Loose Courtyard	Eighteenth Century	Partial loss (less than 50% change)
Sparrow Court	Whitfield	Village	Loose Courtyard	Eighteenth Century	Partial loss (less than 50% change)
Manor Farm	Great Mongeham	Village	L-Plan	Eighteenth Century	Partial loss (less than 50% change)
Lower Twitham Farm	Wingham	Isolated	Regular Courtyard	Eighteenth Century	Partial loss (less than 50% change)
Claypits	Goodnestone	Isolated	Regular Courtyard	Eighteenth Century	Partial loss (less than 50% change)

Name	Parish	Position	Form	Date	Condition
Lydden Court Lodge	Lydden	Isolated	Regular Courtyard	Eighteenth Century	Partial loss (less than 50% change)
North Court Farm	Stourmouth	Village	Regular Courtyard	Eighteenth Century	Partial loss (less than 50% change)
Guilton Farm	Ash	Village	Regular Courtyard	Eighteenth Century	Partial loss (less than 50% change)
Heronden	Eastry	Hamlet	Regular Courtyard	Eighteenth Century	Partial loss (less than 50% change)
Gore Farm	Eastry	Hamlet	Regular Courtyard	Eighteenth Century	Partial loss (less than 50% change)
Wells Farm	Eastry	Isolated	Regular Courtyard	Eighteenth Century	Partial loss (less than 50% change)
Felderland Farm	Worth	Village	Regular Courtyard	Eighteenth Century	Partial loss (less than 50% change)
Upton Farm	Alkham	Village	Regular Courtyard	Eighteenth Century	Partial loss (less than 50% change)
Ripple Farm	Ripple	Isolated	Regular Courtyard	Eighteenth Century	Partial loss (less than 50% change)
Carter House	Worth	Village	Row	Eighteenth Century	Partial loss (less than 50% change)
Little Crockshard Farm	Wingham	Isolated	Dispersed	Nineteenth Century	Partial loss (less than 50% change)
Farmstead in Shatterling	Staple	Hamlet	Dispersed	Nineteenth Century	Partial loss (less than 50% change)
Pinners Farm (Pinners Cottage)	Nonington	Isolated	Dispersed	Nineteenth Century	Partial loss (less than 50% change)
Lodge Farm	Preston	Isolated	Dispersed	Nineteenth Century	Partial loss (less than 50% change)
Farmstead at Durlock	Ash	Isolated	Dispersed	Nineteenth Century	Partial loss (less than 50% change)
Creton Court	Ash	Isolated	Dispersed	Nineteenth Century	Partial loss (less than 50% change)

Name	Parish	Position	Form	Date	Condition
Farmstead in Ash	Ash	Village	Dispersed	Nineteenth Century	Partial loss (less than 50% change)
Great Flemings Farm	Woodnesborough	Hamlet	Dispersed	Nineteenth Century	Partial loss (less than 50% change)
Farmstead E of Great Mongeham Farm	Great Mongeham	Isolated	Dispersed	Nineteenth Century	Partial loss (less than 50% change)
How Wall	Northbourne	Isolated	Dispersed	Nineteenth Century	Partial loss (less than 50% change)
Royal St George's Golf Club (Downs Farm)	Worth	Isolated	Dispersed	Nineteenth Century	Partial loss (less than 50% change)
Farmstead NW of Church Farm	Staple	Village	Dispersed	Nineteenth Century	Partial loss (less than 50% change)
Ladydown Farm	Preston	Isolated	Linear	Nineteenth Century	Partial loss (less than 50% change)
Stone Cross House (Stone Cross Farm)	Sandwich	Isolated	Lineard	Nineteenth Century	Partial loss (less than 50% change)
Little Sandown Farm	Sandwich	Isolated	Lineard	Nineteenth Century	Partial loss (less than 50% change)
Southlands Farm	Ash	Isolated	Loose Courtyard	Nineteenth Century	Partial loss (less than 50% change)
Hearts Delight	Wingham	Isolated	Loose Courtyard	Nineteenth Century	Partial loss (less than 50% change)
Hatchers Farm	Preston	Village	Loose Courtyard	Nineteenth Century	Partial loss (less than 50% change)
Rookery Farm	Preston	Isolated	Loose Courtyard	Nineteenth Century	Partial loss (less than 50% change)
Shatterling Court Farm	Staple	Isolated	Loose Courtyard	Nineteenth Century	Partial loss (less than 50% change)
Little Santon Farm	Preston	Isolated	Loose Courtyard	Nineteenth Century	Partial loss (less than 50% change)

Name	Parish	Position	Form	Date	Condition
Farmstead N of Barnswell Cottage	Staple	Village	Loose Courtyard	Nineteenth Century	Partial loss (less than 50% change)
Paramour Farm	Ash	Isolated	Loose Courtyard	Nineteenth Century	Partial loss (less than 50% change)
Great Knell Farm	Ash	Isolated	Loose Courtyard	Nineteenth Century	Partial loss (less than 50% change)
Onion Bed Farm (Onionbed)	Woodnesborough	Isolated	Loose Courtyard	Nineteenth Century	Partial loss (less than 50% change)
Lower Rowling Farm	Goodnestone	Isolated	Loose Courtyard	Nineteenth Century	Partial loss (less than 50% change)
Lower Heronden Farm	Eastry	Hamlet	Loose Courtyard	Nineteenth Century	Partial loss (less than 50% change)
Brooke Street Farm (Brookestreet Farm)	Ash	Isolated	Loose Courtyard	Nineteenth Century	Partial loss (less than 50% change)
Coldharbour Farm	Northbourne	Isolated	Loose Courtyard	Nineteenth Century	Partial loss (less than 50% change)
Hillside Farm	Great Mongeham	Village	Loose Courtyard	Nineteenth Century	Partial loss (less than 50% change)
Capel Farm	Capel-le-Ferne	Isolated	Loose Courtyard	Nineteenth Century	Partial loss (less than 50% change)
Farmstead in Shephersdwell	Shephersdwell with Coldred	Village	Loose Courtyard	Nineteenth Century	Partial loss (less than 50% change)
Haynes Farm	Shephersdwell with Coldred	Isolated	Loose Courtyard	Nineteenth Century	Partial loss (less than 50% change)
Church Farm	Hougham Without	Hamlet	Loose Courtyard	Nineteenth Century	Partial loss (less than 50% change)
Eastling Down Farm (Heasledown Farm)	Tilmanstone	Isolated	Loose Courtyard	Nineteenth Century	Partial loss (less than 50% change)
Old Rose Farm	Langdon	Hamlet	Loose Courtyard	Nineteenth Century	Partial loss (less than 50% change)

Name	Parish	Position	Form	Date	Condition
Old Files Farm	Langdon	Village	Loose Courtyard	Nineteenth Century	Partial loss (less than 50% change)
Church Farm	Staple	Village	Loose Courtyard	Nineteenth Century	Partial loss (less than 50% change)
Great Walmsteone	Preston	Farmstead Cluster	Loose Courtyard	Nineteenth Century	Partial loss (less than 50% change)
Farmstead in Sholden	Sholden	Village	Loose Courtyard	Nineteenth Century	Partial loss (less than 50% change)
Farmstead SE of Cop Street Farm	Ash	Isolated	L-Pland	Nineteenth Century	Partial loss (less than 50% change)
Farmstead at Four Turnings	Wingham	Isolated	Regular Courtyard	Nineteenth Century	Partial loss (less than 50% change)
Great Rusham Farm	Wingham	Isolated	Regular Courtyard	Nineteenth Century	Partial loss (less than 50% change)
Claypits Farm	Goodnestone	Isolated	Regular Courtyard	Nineteenth Century	Partial loss (less than 50% change)
Farmstead E of Rose Cottage	Staple	Hamlet	Regular Courtyard	Nineteenth Century	Partial loss (less than 50% change)
Overland Farm	Ash	Isolated	Regular Courtyard	Nineteenth Century	Partial loss (less than 50% change)
Hoaden House	Ash	Isolated	Regular Courtyard	Nineteenth Century	Partial loss (less than 50% change)
Cop Street Farm	Ash	Village	Regular Courtyard	Nineteenth Century	Partial loss (less than 50% change)
Farmstead in Ash	Ash	Village	Regular Courtyard	Nineteenth Century	Partial loss (less than 50% change)
Great Weddington (Weddington House)	Ash	Village	Regular Courtyard	Nineteenth Century	Partial loss (less than 50% change)
Middle Heronden	Eastry	Hamlet	Regular Courtyard	Nineteenth Century	Partial loss (less than 50% change)

Name	Parish	Position	Form	Date	Condition
Lower Wenson Farm (Wenson Farm)	Eastry	Isolated	Regular Courtyard	Nineteenth Century	Partial loss (less than 50% change)
Farmstead in Cooper's Street	Ash	Hamlet	Regular Courtyard	Nineteenth Century	Partial loss (less than 50% change)
West Street Farm	Northbourne	Isolated	Regular Courtyard	Nineteenth Century	Partial loss (less than 50% change)
Little London	Lydden	Isolated	Regular Courtyard	Nineteenth Century	Partial loss (less than 50% change)
Great Watersend	Temple Ewell	Isolated	Regular Courtyard	Nineteenth Century	Partial loss (less than 50% change)
Frith Farm	Guston	Isolated	Regular Courtyard	Nineteenth Century	Partial loss (less than 50% change)
Reach Court Farm	St Margaret's at Cliffe	Isolated	Regular Courtyard	Nineteenth Century	Partial loss (less than 50% change)
Chalk Hill Farm	Ringwoud with Kingsdown	Isolated	Regular Courtyard	Nineteenth Century	Partial loss (less than 50% change)
Beacon Lane Farm	Woodnesborough	Village	Regular Courtyard	Nineteenth Century	Partial loss (less than 50% change)
Preston Court	Preston	Church, Manor or other high status farmstead	Regular Courtyard	Nineteenth Century	Partial loss (less than 50% change)
Witherdens Hall	Wingham	Isolated	Regular Courtyard	Nineteenth Century	Partial loss (less than 50% change)
Great Ware Farm (Ware Farm)	Ash	Isolated	Regular Courtyard	Nineteenth Century	Partial loss (less than 50% change)
Farmstead in Weddington	Ash	Village	Regular Courtyard	Nineteenth Century	Partial loss (less than 50% change)
Farmstead in Lower Goldstone	Ash	Village	Regular Courtyard	Nineteenth Century	Partial loss (less than 50% change)
Hacklinge Farm	Worth	Isolated	Regular Courtyard	Nineteenth Century	Partial loss (less than 50% change)

Name	Parish	Position	Form	Date	Condition
Walnut Tree Farm	Sholden	Isolated	Regular Courtyard	Nineteenth Century	Partial loss (less than 50% change)
Dairy Farm	Denton with Wootton	Village	Regular Courtyard	Nineteenth Century	Partial loss (less than 50% change)
Coxhill Farm	Shepherdswell with Coldred	Hamlet	Regular Courtyard	Nineteenth Century	Partial loss (less than 50% change)
Meggett Farm (Maggot Farm)	Alkham	Isolated	Regular Courtyard	Nineteenth Century	Partial loss (less than 50% change)
Farmstead in Lydden	Lydden	Village	Regular Courtyard	Nineteenth Century	Partial loss (less than 50% change)
Elms Farm	Hougham Without	Isolated	Regular Courtyard	Nineteenth Century	Partial loss (less than 50% change)
Little Farthingloe Farm	Dover	Hamlet	Regular Courtyard	Nineteenth Century	Partial loss (less than 50% change)
Lenacre Court	Whitfield	Village	Regular Courtyard	Nineteenth Century	Partial loss (less than 50% change)
Vicarage Farm	Langdon	Hamlet	Regular Courtyard	Nineteenth Century	Partial loss (less than 50% change)
Forstal Farm	Langdon	Hamlet	Regular Courtyard	Nineteenth Century	Partial loss (less than 50% change)
Great Pineham	Whitfield	Hamlet	Regular Courtyard	Nineteenth Century	Partial loss (less than 50% change)
Sutton Court Farm	Sutton	Village	Regular Courtyard	Nineteenth Century	Partial loss (less than 50% change)
Coldblow Farm	Ripple	Isolated	Regular Courtyard	Nineteenth Century	Partial loss (less than 50% change)
Dixs Farm	Woodnesborough	Isolated	Regular Courtyard	Nineteenth Century	Partial loss (less than 50% change)
Marlborough Farm	Woodnesborough	Village	Regular Courtyard	Uncertain	Partial loss (less than 50% change)
Grove Manor Farm	Woodnesborough	Isolated	Regular Courtyard	Uncertain	Partial loss (less than 50% change)

Name	Parish	Position	Form	Date	Condition
Wingleton Farm (Winkland Farm)	Sutton	Isolated	Regular Courtyard	Uncertain	Partial loss (less than 50% change)
Coldred Manor	Shepherdswell with Coldred	Isolated	Dispersed	Pre 1600	Significant loss (more than 50% change)
Gander Court Farm	Staple	Village	Loose Courtyard	Pre 1600	Significant loss (more than 50% change)
Paramour Grange	Ash	Isolated	Loose Courtyard	Pre 1600	Significant loss (more than 50% change)
The Manor House (Lower Weddington Farm)	Ash	Hamlet	Loose Courtyard	Pre 1600	Significant loss (more than 50% change)
Christian Court	Woodnesborough	Isolated	Loose Courtyard	Pre 1600	Significant loss (more than 50% change)
Parsonage Farm	Woodnesborough	Village	Loose Courtyard	Pre 1600	Significant loss (more than 50% change)
Almonry Farm (Church Farm)	Northbourne	Village	Loose Courtyard	Pre 1600	Significant loss (more than 50% change)
Tappington Farm	Denton with Wootton	Isolated	Loose Courtyard	Pre 1600	Significant loss (more than 50% change)
Hopton's Farm	Alkham	Village	Loose Courtyard	Pre 1600	Significant loss (more than 50% change)
Long Lane Farm	Shepherdswell with Coldred	Isolated	Loose Courtyard	Pre 1600	Significant loss (more than 50% change)
Great Napchester Farm	Sutton	Farmstead Cluster	Loose Courtyard	Pre 1600	Significant loss (more than 50% change)
Walleys Court	St Margaret's at Cliffe	Hamlet	Loose Courtyard	Pre 1600	Significant loss (more than 50% change)
Court Lodge Farm	Ringwoud with Kingsdown	Village	Loose Courtyard	Pre 1600	Significant loss (more than 50% change)
Wanstone Farm	St Margaret's at Cliffe	Isolated	Loose Courtyard	Pre 1600	Significant loss (more than 50% change)

Name	Parish	Position	Form	Date	Condition
Summerfield Farm	Woodnesborough	Isolated	Loose Courtyard	Pre 1600	Significant loss (more than 50% change)
Ratling Court	Aylesham	Hamlet	Regular Courtyard	Pre 1600	Significant loss (more than 50% change)
Stourmouth House	Stourmouth	Village	Regular Courtyard	Pre 1600	Significant loss (more than 50% change)
Nash Court Farm	Ash	Isolated	Regular Courtyard	Pre 1600	Significant loss (more than 50% change)
Summerfield Farm	Staple	Isolated	Regular Courtyard	Pre 1600	Significant loss (more than 50% change)
Molland	Ash	Isolated	Regular Courtyard	Pre 1600	Significant loss (more than 50% change)
Foulmead Farm	Sholden	Isolated	Regular Courtyard	Pre 1600	Significant loss (more than 50% change)
Hogbrook Farm	Alkham	Village	Regular Courtyard	Pre 1600	Significant loss (more than 50% change)
Wingham Court	Wingham	Village	Regular Courtyard	Pre 1600	Significant loss (more than 50% change)
Perry Farm	Wingham	Farmstead Cluster	Regular Courtyard	Pre 1600	Significant loss (more than 50% change)
Bonnington Farm	Goodnestone	Isolated	Regular Courtyard	Pre 1600	Significant loss (more than 50% change)
Yew Tree Farm	Goodnestone	Village	Regular Courtyard	Pre 1600	Significant loss (more than 50% change)
Uphousden Farm (Housden Farm)	Ash	Isolated	Regular Courtyard	Pre 1600	Significant loss (more than 50% change)
Eastry Court Farm	Eastry	Village	Regular Courtyard	Pre 1600	Significant loss (more than 50% change)
Ham Manor	Northbourne	Hamlet	Regular Courtyard	Pre 1600	Significant loss (more than 50% change)

Name	Parish	Position	Form	Date	Condition
Cottington Court Farm (Cottingtoncourt Farm)	Sholden	Isolated	Regular Courtyard	Pre 1600	Significant loss (more than 50% change)
Lodgelees Farm	Denton with Wootton	Isolated	Regular Courtyard	Pre 1600	Significant loss (more than 50% change)
Great Everden	Alkham	Isolated	Regular Courtyard	Pre 1600	Significant loss (more than 50% change)
Gedinge Farm (Geddins)	Denton with Wootton	Isolated	Regular Courtyard	Pre 1600	Significant loss (more than 50% change)
Marston Hall	Langdon	Village	Regular Courtyard	Pre 1600	Significant loss (more than 50% change)
Oxney Court	St Margaret's at Cliffe	Isolated	Regular Courtyard	Pre 1600	Significant loss (more than 50% change)
Tudor House	Wingham	Isolated	Dispersed	Seventeenth Century	Significant loss (more than 50% change)
Newhouse Farm	Stourmouth	Village	Dispersed	Seventeenth Century	Significant loss (more than 50% change)
Beaute Farm	Staple	Isolated	Loose Courtyard	Seventeenth Century	Significant loss (more than 50% change)
Chalk Farm	Woodnesborough	Village	Loose Courtyard	Seventeenth Century	Significant loss (more than 50% change)
Ringleton Manor (Ringleton Farm)	Woodnesborough	Isolated	Loose Courtyard	Seventeenth Century	Significant loss (more than 50% change)
Little Statenborough	Eastry	Hamlet	Loose Courtyard	Seventeenth Century	Significant loss (more than 50% change)
St Margarets Farm	Sutton	Farmstead Cluster	Loose Courtyard	Seventeenth Century	Significant loss (more than 50% change)
Old Court Farm	Aylesham	Isolated	Regular Courtyard	Seventeenth Century	Significant loss (more than 50% change)
Little Selson	Eastry	Isolated	Regular Courtyard	Seventeenth Century	Significant loss (more than 50% change)

Name	Parish	Position	Form	Date	Condition
Guston Court (Guston Farm)	Ash	Isolated	Regular Courtyard	Seventeenth Century	Significant loss (more than 50% change)
Poulton Farm	Woodnesborough	Isolated	Regular Courtyard	Seventeenth Century	Significant loss (more than 50% change)
Stoneheap Farm	Sutton	Isolated	Regular Courtyard	Seventeenth Century	Significant loss (more than 50% change)
Manor Farm (Little Mongeham Farm)	Sutton	Hamlet	Regular Courtyard	Seventeenth Century	Significant loss (more than 50% change)
Parsonage Farm	Sutton	Village	Dispersed	Eighteenth Century	Significant loss (more than 50% change)
Church Farm	Eythorne	Village	Loose Courtyard	Eighteenth Century	Significant loss (more than 50% change)
Golden Bell	Tilmanstone	Village	Loose Courtyard	Eighteenth Century	Significant loss (more than 50% change)
Marshborough Farm	Woodnesborough	Village	Loose Courtyard	Eighteenth Century	Significant loss (more than 50% change)
Rose Hill Farm	Hougham Without	Village	Loose Courtyard	Eighteenth Century	Significant loss (more than 50% change)
Wigmore Court (Wigmore Farm)	Eythorne	Isolated	Loose Courtyard	Eighteenth Century	Significant loss (more than 50% change)
Goldstone Court	Ash	Village	Regular Courtyard	Eighteenth Century	Significant loss (more than 50% change)
Dambridge Farm	Wingham	Isolated	Regular Courtyard	Eighteenth Century	Significant loss (more than 50% change)
Street Farm	Preston	Village	Regular Courtyard	Eighteenth Century	Significant loss (more than 50% change)
Hardacre Farm	Preston	Village	Regular Courtyard	Eighteenth Century	Significant loss (more than 50% change)
Santon Farm	Preston	Isolated	Regular Courtyard	Eighteenth Century	Significant loss (more than 50% change)

Name	Parish	Position	Form	Date	Condition
Upper Goldstone Farm	Ash	Village	Regular Courtyard	Eighteenth Century	Significant loss (more than 50% change)
Castle Farm (Richborough Castle Farm)	Ash	Farmstead Cluster	Regular Courtyard	Eighteenth Century	Significant loss (more than 50% change)
Church Farm	Ripple	Isolated	Regular Courtyard	Eighteenth Century	Significant loss (more than 50% change)
Home Farm	Tilmanstone	Parkland	Regular Courtyard	Eighteenth Century	Significant loss (more than 50% change)
Millers Farm	Goodnestone	Village	Dispersed	Nineteenth Century	Significant loss (more than 50% change)
Farmstead W of Chalk Farm	Staple	Isolated	Dispersed	Nineteenth Century	Significant loss (more than 50% change)
St Bartlemas	Sandwich	Village	Dispersed	Nineteenth Century	Significant loss (more than 50% change)
Shelvin Farm	Denton with Wootton	Isolated	Dispersed	Nineteenth Century	Significant loss (more than 50% change)
Hermitage Farm	Alkham	Isolated	Dispersed	Nineteenth Century	Significant loss (more than 50% change)
Fryers Fern Farm	Alkham	Isolated	Dispersed	Nineteenth Century	Significant loss (more than 50% change)
Upper Westhill Farm	Alkham	Village	Dispersed	Nineteenth Century	Significant loss (more than 50% change)
Chilton Farm	Alkham	Isolated	Dispersed	Nineteenth Century	Significant loss (more than 50% change)
Farmstead in Ashley	Sutton	Village	Dispersed	Nineteenth Century	Significant loss (more than 50% change)
Studdal House Farm	Sutton	Farmstead Cluster	Dispersed	Nineteenth Century	Significant loss (more than 50% change)
Bere Farm	St Margaret's at Cliffe	Isolated	Dispersed	Nineteenth Century	Significant loss (more than 50% change)
Ringwoud House	Ringwoud with Kingsdown	Village	Dispersed	Nineteenth Century	Significant loss (more than 50% change)

Name	Parish	Position	Form	Date	Condition
White Farm (Woodhill Farm)	Ringwold with Kingsdown	Isolated	Dispersed	Nineteenth Century	Significant loss (more than 50% change)
Crockshard Farm	Wingham	Isolated	Loose Courtyard	Nineteenth Century	Significant loss (more than 50% change)
Marleybrooks Farm	Preston	Isolated	Loose Courtyard	Nineteenth Century	Significant loss (more than 50% change)
Russell Farm	Stourmouth	Village	Loose Courtyard	Nineteenth Century	Significant loss (more than 50% change)
Farmstead W of Shatterling Court Farm	Staple	Isolated	Loose Courtyard	Nineteenth Century	Significant loss (more than 50% change)
Yew Tree Farm	Goodnestone	Village	Loose Courtyard	Nineteenth Century	Significant loss (more than 50% change)
Church Street Farm	Nonington	Village	Loose Courtyard	Nineteenth Century	Significant loss (more than 50% change)
Farmstead SE of Crixhall Farm	Staple	Isolated	Loose Courtyard	Nineteenth Century	Significant loss (more than 50% change)
Farmstead in Ware	Ash	Village	Loose Courtyard	Nineteenth Century	Significant loss (more than 50% change)
Knell Farm	Ash	Isolated	Loose Courtyard	Nineteenth Century	Significant loss (more than 50% change)
Thornton Farm	Tilmanstone	Isolated	Loose Courtyard	Nineteenth Century	Significant loss (more than 50% change)
Great Flemings Farm	Woodnesborough	Hamlet	Loose Courtyard	Nineteenth Century	Significant loss (more than 50% change)
Farmstead in Lower Goldstone	Ash	Village	Loose Courtyard	Nineteenth Century	Significant loss (more than 50% change)
Farmstead in Eastry	Eastry	Village	Loose Courtyard	Nineteenth Century	Significant loss (more than 50% change)
Poulders Farm (Great Poulders Farm)	Sandwich	Isolated	Loose Courtyard	Nineteenth Century	Significant loss (more than 50% change)
Telegraph Farm	Northbourne	Isolated	Loose Courtyard	Nineteenth Century	Significant loss (more than 50% change)

Name	Parish	Position	Form	Date	Condition
Adelaide Farm	Sholden	Isolated	Loose Courtyard	Nineteenth Century	Significant loss (more than 50% change)
Temptye Farm	Worth	Isolated	Loose Courtyard	Nineteenth Century	Significant loss (more than 50% change)
Farmstead in Great Mongeham	Great Mongeham	Isolated	Loose Courtyard	Nineteenth Century	Significant loss (more than 50% change)
Farmstead in Sholden	Sholden	Village	Loose Courtyard	Nineteenth Century	Significant loss (more than 50% change)
Gatteridge Farm	Denton with Wootton	Isolated	Loose Courtyard	Nineteenth Century	Significant loss (more than 50% change)
Hockley Sole	Capel-le-Ferne	Isolated	Loose Courtyard	Nineteenth Century	Significant loss (more than 50% change)
Brimsdale Farm	Eyethorne	Isolated	Loose Courtyard	Nineteenth Century	Significant loss (more than 50% change)
Hougham Lodge	Dover	Isolated	Loose Courtyard	Nineteenth Century	Significant loss (more than 50% change)
Minacre Farm	Sutton	Isolated	Loose Courtyard	Nineteenth Century	Significant loss (more than 50% change)
Farmstead in Ashley	Sutton	Village	Loose Courtyard	Nineteenth Century	Significant loss (more than 50% change)
Guston Cottage	Guston	Village	Loose Courtyard	Nineteenth Century	Significant loss (more than 50% change)
Forge Farm	Sutton	Isolated	Loose Courtyard	Nineteenth Century	Significant loss (more than 50% change)
Westcliffe Farm (West Cliffe Farm)	St Margaret's at Cliffe	Hamlet	Loose Courtyard	Nineteenth Century	Significant loss (more than 50% change)
Bockhill Farm	St Margaret's at Cliffe	Isolated	Loose Courtyard	Nineteenth Century	Significant loss (more than 50% change)
Great Cauldham Farm	Capel-le-Ferne	Isolated	Loose Courtyard	Nineteenth Century	Significant loss (more than 50% change)
Farmstead W of Worth Church	Worth	Village	Loose Courtyard	Nineteenth Century	Significant loss (more than 50% change)

Name	Parish	Position	Form	Date	Condition
Yard in Barfreston	Eythorne	Village	Regular Courtyard	Nineteenth Century	Significant loss (more than 50% change)
Kettington Farm	Nonington	Isolated	Regular Courtyard	Nineteenth Century	Significant loss (more than 50% change)
Chapel Farm	Staple	Hamlet	Regular Courtyard	Nineteenth Century	Significant loss (more than 50% change)
Twitham Court Farm	Ash	Isolated	Regular Courtyard	Nineteenth Century	Significant loss (more than 50% change)
Ringlemere Farm	Woodnesborough	Isolated	Regular Courtyard	Nineteenth Century	Significant loss (more than 50% change)
Marley Farm	Northbourne	Isolated	Regular Courtyard	Nineteenth Century	Significant loss (more than 50% change)
Westcourt Farm (West Court Farm)	Shepherdswell with Coldred	Isolated	Regular Courtyard	Nineteenth Century	Significant loss (more than 50% change)
Great Satmar	Capel-le-Ferne	Hamlet	Regular Courtyard	Nineteenth Century	Significant loss (more than 50% change)
Little Watersend Farm	Lydden	Isolated	Regular Courtyard	Nineteenth Century	Significant loss (more than 50% change)
Farmstead NE of Great Watersend	Temple Ewell	Isolated	Regular Courtyard	Nineteenth Century	Significant loss (more than 50% change)
Homestead Farm	Sutton	Farmstead Cluster	Regular Courtyard	Nineteenth Century	Significant loss (more than 50% change)
Little Knell Farm	Ash	Isolated	Regular Courtyard	Nineteenth Century	Significant loss (more than 50% change)
Little Fleming Farm (Little Flemings Farm)	Woodnesborough	Hamlet	Regular Courtyard	Nineteenth Century	Significant loss (more than 50% change)
Hammill Court	Woodnesborough	Isolated	Regular Courtyard	Nineteenth Century	Significant loss (more than 50% change)
New Purchase Farm	Tilmanstone	Isolated	Regular Courtyard	Nineteenth Century	Significant loss (more than 50% change)
Each Manor Farm (Each Farm)	Woodnesborough	Isolated	Regular Courtyard	Nineteenth Century	Significant loss (more than 50% change)

Name	Parish	Position	Form	Date	Condition
Eachend Farm	Woodnesborough	Hamlet	Regular Courtyard	Nineteenth Century	Significant loss (more than 50% change)
Betteshanger	Northbourne	Parkland	Regular Courtyard	Nineteenth Century	Significant loss (more than 50% change)
Mercers Farm	Northbourne	Village	Regular Courtyard	Nineteenth Century	Significant loss (more than 50% change)
Kennels Farm (Kennel Farm)	Sholden	Isolated	Regular Courtyard	Nineteenth Century	Significant loss (more than 50% change)
Farmstead SE of Kennerls Farm	Deal	Isolated	Regular Courtyard	Nineteenth Century	Significant loss (more than 50% change)
Fernfield Farm	Alkham	Isolated	Regular Courtyard	Nineteenth Century	Significant loss (more than 50% change)
Pickleden Lodge	Denton with Wootton	Isolated	Regular Courtyard	Nineteenth Century	Significant loss (more than 50% change)
Ellinge	Alkham	Isolated	Regular Courtyard	Nineteenth Century	Significant loss (more than 50% change)
Drellingore Farm	Alkham	Isolated	Regular Courtyard	Nineteenth Century	Significant loss (more than 50% change)
Hollingbury Farm	Capel-le-Ferne	Village	Regular Courtyard	Nineteenth Century	Significant loss (more than 50% change)
Malmins Farm	Alkham	Village	Regular Courtyard	Nineteenth Century	Significant loss (more than 50% change)
Little Satmar Farm	Capel-le-Ferne	Hamlet	Regular Courtyard	Nineteenth Century	Significant loss (more than 50% change)
Capel Church Farm	Capel-le-Ferne	Hamlet	Regular Courtyard	Nineteenth Century	Significant loss (more than 50% change)
Farmstead at Uptonwood	Shepherdswell with Coldred	Isolated	Regular Courtyard	Nineteenth Century	Significant loss (more than 50% change)
St Siberts Place (Sibertswold Place)	Shepherdswell with Coldred	Isolated	Regular Courtyard	Nineteenth Century	Significant loss (more than 50% change)
Farmstead NE of Chilli Farm	Shepherdswell with Coldred	Hamlet	Regular Courtyard	Nineteenth Century	Significant loss (more than 50% change)

Name	Parish	Position	Form	Date	Condition
Stonehall Farm (Stone Hall)	Lydden	Isolated	Regular Courtyard	Nineteenth Century	Significant loss (more than 50% change)
Poulton Farm	Hougham Without	Isolated	Regular Courtyard	Nineteenth Century	Significant loss (more than 50% change)
Cox Farm	Hougham Without	Village	Regular Courtyard	Nineteenth Century	Significant loss (more than 50% change)
Great Hougham Court	Hougham Without	Isolated	Regular Courtyard	Nineteenth Century	Significant loss (more than 50% change)
Kearnsey Court Farm	Temple Ewell	Village	Regular Courtyard	Nineteenth Century	Significant loss (more than 50% change)
Great Farthingloe Farm	Dover	Isolated	Regular Courtyard	Nineteenth Century	Significant loss (more than 50% change)
Bewsbury Cross Farm	Whitfield	Isolated	Regular Courtyard	Nineteenth Century	Significant loss (more than 50% change)
West Studdal Farm	Sutton	Isolated	Regular Courtyard	Nineteenth Century	Significant loss (more than 50% change)
Guston Court Farm (Gustoncourt Farm)	Guston	Village	Regular Courtyard	Nineteenth Century	Significant loss (more than 50% change)
Appleton Farm	Langdon	Isolated	Regular Courtyard	Nineteenth Century	Significant loss (more than 50% change)
Martin Farm	Langdon	Village	Regular Courtyard	Nineteenth Century	Significant loss (more than 50% change)
East Valley Farm	St Margaret's at Cliffe	Isolated	Regular Courtyard	Nineteenth Century	Significant loss (more than 50% change)
East Bottom Farm	Ringwould with Kingsdown	Isolated	Regular Courtyard	Nineteenth Century	Significant loss (more than 50% change)
Farmstead in Bockell	St Margaret's at Cliffe	Isolated	Regular Courtyard	Nineteenth Century	Significant loss (more than 50% change)
Farmstead W of Sholden Farm	Sholden	Village	Regular Courtyard	Nineteenth Century	Significant loss (more than 50% change)

Name	Parish	Position	Form	Date	Condition
Farmstead in Little Statenborough	Eastry	Village	Regular Courtyard	Uncertain	Significant loss (more than 50% change)
Wood Cottage (Great Wenderton farm)	Wingham	Isolated	Loose Courtyard	Pre 1600	Farmhouse only survives
Forstal Farm	Preston	Village	Loose Courtyard	Pre 1600	Farmhouse only survives
Gooseberry Hall Farm (Goosberryhall)	Nonington	Isolated	Loose Courtyard	Pre 1600	Farmhouse only survives
Shelvin Grove	Denton with Wootton	Isolated	Loose Courtyard	Pre 1600	Farmhouse only survives
Halton Court	Alkham	Village	Loose Courtyard	Pre 1600	Farmhouse only survives
Flax Court	Eyethorne	Village	Regular Courtyard	Pre 1600	Farmhouse only survives
Hoaden Farm	Ash	Isolated	Regular Courtyard	Pre 1600	Farmhouse only survives
Cock's Farm	Ash	Village	Dispersed	Seventeenth Century	Farmhouse only survives
Elizabethan Cottage	Goodnestone	Isolated	Dispersed	Seventeenth Century	Farmhouse only survives
Churchgate Farm	Woodnesborough	Village	Dispersed	Seventeenth Century	Farmhouse only survives
Watercress Cottage	Wingham	Isolated	Loose Courtyard	Seventeenth Century	Farmhouse only survives
Little Nash Farm	Ash	Isolated	Loose Courtyard	Seventeenth Century	Farmhouse only survives
Vine Farm	Northbourne	Village	Loose Courtyard	Seventeenth Century	Farmhouse only survives
The Dower House	Sholden	Village	Loose Courtyard	Seventeenth Century	Farmhouse only survives
Worth Farm	Worth	Village	Loose Courtyard	Seventeenth Century	Farmhouse only survives
School Farm	Ash	Village	Regular Courtyard	Seventeenth Century	Farmhouse only survives
Church Farm	Worth	Village	Regular Courtyard	Seventeenth Century	Farmhouse only survives
Stone Hall	Great Mongeham	Village	Regular Courtyard	Seventeenth Century	Farmhouse only survives
Chilli Farm	Shepherdswell with Coldred	Hamlet	Regular Courtyard	Seventeenth Century	Farmhouse only survives
Home Farm	Ringwoud with Kingsdown	Village	Regular Courtyard	Seventeenth Century	Farmhouse only survives
Holly Farm	Deal	Village	Dispersed	Eighteenth Century	Farmhouse only survives

Name	Parish	Position	Form	Date	Condition
Sweech Cottage	Preston	Isolated	Loose Courtyard	Eighteenth Century	Farmhouse only survives
Little Perry Farm	Preston	Farmstead Cluster	Loose Courtyard	Eighteenth Century	Farmhouse only survives
Vine Farm	Tilmanstone	Village	Loose Courtyard	Eighteenth Century	Farmhouse only survives
Old Chalksole Farm (Chalksole)	Alkham	Isolated	Loose Courtyard	Eighteenth Century	Farmhouse only survives
Ratling Farm	Aylesham	Hamlet	Regular Courtyard	Eighteenth Century	Farmhouse only survives
Nash Farm (Little Nash Farm)	Ash	Isolated	Regular Courtyard	Eighteenth Century	Farmhouse only survives
Sheerwater Farm	Ash	Isolated	Regular Courtyard	Eighteenth Century	Farmhouse only survives
Sandhills Farm	Ash	Isolated	Regular Courtyard	Eighteenth Century	Farmhouse only survives
Farmstead W of Vine Cottage	Nonington	Village	Regular Courtyard	Eighteenth Century	Farmhouse only survives
Chapel Farm	Tilmanstone	Village	Regular Courtyard	Eighteenth Century	Farmhouse only survives
Walmer Court	Walmer	Village	Regular Courtyard	Eighteenth Century	Farmhouse only survives
Street Farm	Denton with Wootton	Isolated	Regular Courtyard	Eighteenth Century	Farmhouse only survives
Black Swan Farm	Hougham Without	Village	Regular Courtyard	Eighteenth Century	Farmhouse only survives
Farmstead on Care Lane	Goodnestone	Isolated	Dispersed	Nineteenth Century	Farmhouse only survives
Farmstead adjacent to St Michaels	Nonington	Village	Dispersed	Nineteenth Century	Farmhouse only survives
Mill Road Farm	Staple	Isolated	Dispersed	Nineteenth Century	Farmhouse only survives
Farmstead SSE of Sheerwater Farm	Ash	Isolated	Dispersed	Nineteenth Century	Farmhouse only survives
Orchards Farm	Ash	Village	Dispersed	Nineteenth Century	Farmhouse only survives
Farmstead W of Cop Street Farm	Ash	Village	Dispersed	Nineteenth Century	Farmhouse only survives
Farmstead SW of Sandhills Farm	Ash	Isolated	Dispersed	Nineteenth Century	Farmhouse only survives
Bride Farm (Brides Farm)	Ash	Isolated	Dispersed	Nineteenth Century	Farmhouse only survives

Name	Parish	Position	Form	Date	Condition
Burnt Barn	Northbourne	Isolated	Dispersed	Nineteenth Century	Farmhouse only survives
Farmstead at Chalksole Green	Alkham	Hamlet	Dispersed	Nineteenth Century	Farmhouse only survives
Farmstead in Ewell Minnis	Alkham	Village	Dispersed	Nineteenth Century	Farmhouse only survives
River Minnis Farm	River	Isolated	Dispersed	Nineteenth Century	Farmhouse only survives
Farmstead at Eyethorne Green	Eyethorne	Hamlet	Dispersed	Nineteenth Century	Farmhouse only survives
Farmstead in Finglesham	Northbourne	Village	Dispersed	Nineteenth Century	Farmhouse only survives
Hills Court	Ash	Isolated	Lineard	Nineteenth Century	Farmhouse only survives
Court Wood	Hougham Without	Isolated	Lineard	Nineteenth Century	Farmhouse only survives
Farmstead in Ackholt	Aylesham	Isolated	Loose Courtyard	Nineteenth Century	Farmhouse only survives
North Poulders Farm	Stourmouth	Village	Loose Courtyard	Nineteenth Century	Farmhouse only survives
Gypsy Court	Staple	Isolated	Loose Courtyard	Nineteenth Century	Farmhouse only survives
Little Shatterling Farm	Staple	Isolated	Loose Courtyard	Nineteenth Century	Farmhouse only survives
Little Hoaden Farm	Ash	Isolated	Loose Courtyard	Nineteenth Century	Farmhouse only survives
Fairview Farm	Ash	Village	Loose Courtyard	Nineteenth Century	Farmhouse only survives
Wass Farm	Ash	Village	Loose Courtyard	Nineteenth Century	Farmhouse only survives
Rowling Farm Cottages	Goodnestone	Isolated	Loose Courtyard	Nineteenth Century	Farmhouse only survives
Little Weddington Farm	Ash	Village	Loose Courtyard	Nineteenth Century	Farmhouse only survives
Farmstead in Tilmanstone	Tilmanstone	Village	Loose Courtyard	Nineteenth Century	Farmhouse only survives
South Court	Tilmanstone	Village	Loose Courtyard	Nineteenth Century	Farmhouse only survives
Farmstead in Tilmanstone	Tilmanstone	Village	Loose Courtyard	Nineteenth Century	Farmhouse only survives
Little East Street Farm	Ash	Isolated	Loose Courtyard	Nineteenth Century	Farmhouse only survives
Sparrow Castle Farm	Ash	Isolated	Loose Courtyard	Nineteenth Century	Farmhouse only survives
Puttocks Down Farm	Sandwich	Isolated	Loose Courtyard	Nineteenth Century	Farmhouse only survives

Name	Parish	Position	Form	Date	Condition
Farmstead W of Worth	Worth	Isolated	Loose Courtyard	Nineteenth Century	Farmhouse only survives
Farmstead SW of Pastoral Farm	Denton with Wootton	Isolated	Loose Courtyard	Nineteenth Century	Farmhouse only survives
Hill House Farm	Denton with Wootton	Isolated	Loose Courtyard	Nineteenth Century	Farmhouse only survives
Lone Barn Farm	Alkham	Isolated	Loose Courtyard	Nineteenth Century	Farmhouse only survives
Copt Hill	Capel-le-Ferne	Isolated	Loose Courtyard	Nineteenth Century	Farmhouse only survives
Crabble Farm	River	Village	Loose Courtyard	Nineteenth Century	Farmhouse only survives
Church Farm	Whitfield	Hamlet	Loose Courtyard	Nineteenth Century	Farmhouse only survives
Little Napchester Farm	Sutton	Farmstead Cluster	Loose Courtyard	Nineteenth Century	Farmhouse only survives
Church Farm	Langdon	Hamlet	Loose Courtyard	Nineteenth Century	Farmhouse only survives
Farmstead in Guston	Guston	Village	Loose Courtyard	Nineteenth Century	Farmhouse only survives
Farmstead in Martin	Langdon	Village	Loose Courtyard	Nineteenth Century	Farmhouse only survives
Farmstead in Ackholt	Aylesham	Isolated	Regular Courtyard	Nineteenth Century	Farmhouse only survives
Church Hill Farm	Preston	Isolated	Regular Courtyard	Nineteenth Century	Farmhouse only survives
Spindle Farm	Ash	Isolated	Regular Courtyard	Nineteenth Century	Farmhouse only survives
Warehorn Farm	Ash	Isolated	Regular Courtyard	Nineteenth Century	Farmhouse only survives
Farmstead SW of Upper Goldstone Farm	Ash	Village	Regular Courtyard	Nineteenth Century	Farmhouse only survives
Farmstead W of Ringlemere Farm	Woodnesborough	Isolated	Regular Courtyard	Nineteenth Century	Farmhouse only survives
Sparrow Court	Great Mongeham	Isolated	Regular Courtyard	Nineteenth Century	Farmhouse only survives
Farmstead in Upper Deal	Deal	Village	Regular Courtyard	Nineteenth Century	Farmhouse only survives
Home Farm	Wingham	Village	Regular Courtyard	Nineteenth Century	Farmhouse only survives
Court Farm	Preston	Village	Regular Courtyard	Nineteenth Century	Farmhouse only survives
Venson Farm	Eastry	Isolated	Regular Courtyard	Nineteenth Century	Farmhouse only survives

Name	Parish	Position	Form	Date	Condition
Farmstead N of Vine Farm	Tilmanstone	Village	Regular Courtyard	Nineteenth Century	Farmhouse only survives
Links Farm	Worth	Isolated	Regular Courtyard	Nineteenth Century	Farmhouse only survives
Solleys Farm	Worth	Village	Regular Courtyard	Nineteenth Century	Farmhouse only survives
Minnis Farm	Worth	Isolated	Regular Courtyard	Nineteenth Century	Farmhouse only survives
New Downs Farm	Worth	Isolated	Regular Courtyard	Nineteenth Century	Farmhouse only survives
Farmstead in Deal	Deal	Village	Regular Courtyard	Nineteenth Century	Farmhouse only survives
Snodehill Farm	Denton with Wootton	Isolated	Regular Courtyard	Nineteenth Century	Farmhouse only survives
Wickham Bushes	Lydden	Isolated	Regular Courtyard	Nineteenth Century	Farmhouse only survives
South Alkham Farm	Alkham	Village	Regular Courtyard	Nineteenth Century	Farmhouse only survives
Monkton Court	Eyethorne	Hamlet	Regular Courtyard	Nineteenth Century	Farmhouse only survives
Abbot's Land Farm	Capel-le-Ferne	Isolated	Regular Courtyard	Nineteenth Century	Farmhouse only survives
Walton	Eastry	Village	Regular Courtyard	Nineteenth Century	Farmhouse only survives
Sholden Farm	Sholden	Village	Regular Courtyard	Nineteenth Century	Farmhouse only survives
The Vicarage	Shepherdswell with Coldred	Church, Manor or other high status farmstead	Regular Courtyard	Nineteenth Century	Farmhouse only survives
Little Rusham Farm	Wingham	Isolated	Dispersed	Nineteenth Century	Total change (complete alteration to plan)
Smithfield Farm	Alkham	Isolated	Dispersed	Nineteenth Century	Total change (complete alteration to plan)
Elms Vale	Dover	Isolated	Dispersed	Nineteenth Century	Total change (complete alteration to plan)
Little Poulders Farm	Sandwich	Isolated	Loose Courtyard	Nineteenth Century	Total change (complete alteration to plan)

Name	Parish	Position	Form	Date	Condition
Homemead Farm	Worth	Isolated	Loose Courtyard	Nineteenth Century	Total change (complete alteration to plan)
Swanton Farm	Lydden	Isolated	Loose Courtyard	Nineteenth Century	Total change (complete alteration to plan)
Chalksole Green Farm	Alkham	Hamlet	Loose Courtyard	Nineteenth Century	Total change (complete alteration to plan)
Vale Farm	Sutton	Farmstead Cluster	Loose Courtyard	Nineteenth Century	Total change (complete alteration to plan)
Little Cauldham Farm	Capel-le-Ferne	Isolated	Loose Courtyard	Nineteenth Century	Total change (complete alteration to plan)
Farmstead in Coombe	Woodnesborough	Parkland	Regular Courtyard	Nineteenth Century	Total change (complete alteration to plan)
Barville Farm	Tilmanstone	Isolated	Regular Courtyard	Nineteenth Century	Total change (complete alteration to plan)
Garlinge Farm	Ripple	Isolated	Regular Courtyard	Nineteenth Century	Total change (complete alteration to plan)
Farmstead SE of Smithfield Farm	Alkham	Isolated	Regular Courtyard	Nineteenth Century	Total change (complete alteration to plan)
Farmstead in Hog Green	Great Mongeham	Hamlet	Dispersed	Nineteenth Century	Farmhouse/outfarm totally demolished
Farmstead SE of Foulmead Farm	Sholden	Isolated	Dispersed	Nineteenth Century	Farmhouse/outfarm totally demolished
Farmstead on Bowling Green Road	Deal	Isolated	Dispersed	Nineteenth Century	Farmhouse/outfarm totally demolished
Farmstead SW of Parkside Farm	Denton with Wootton	Isolated	Dispersed	Nineteenth Century	Farmhouse/outfarm totally demolished

Name	Parish	Position	Form	Date	Condition
River Minnis Farm	Alkham	Isolated	Dispersed	Nineteenth Century	Farmhouse/outfarm totally demolished
Chapel Farm	Sutton	Village	Dispersed	Nineteenth Century	Farmhouse/outfarm totally demolished
Green Lane Farm	Dover	Isolated	Dispersed	Nineteenth Century	Farmhouse/outfarm totally demolished
Castle Hill Farm	Guston	Isolated	Dispersed	Nineteenth Century	Farmhouse/outfarm totally demolished
Farmstead in Coldred Street	Shepherdswell with Coldred	Village	Dispersed	Nineteenth Century	Farmhouse/outfarm totally demolished
Farmstead NW of Rat's Castle	Wingham	Isolated	Loose Courtyard	Nineteenth Century	Farmhouse/outfarm totally demolished
Soles Court	Nonington	Isolated	Loose Courtyard	Nineteenth Century	Farmhouse/outfarm totally demolished
Farmstead NNE of Great Pedding Farm	Ash	Isolated	Loose Courtyard	Nineteenth Century	Farmhouse/outfarm totally demolished
Elmton Farm	Eythorne	Isolated	Loose Courtyard	Nineteenth Century	Farmhouse/outfarm totally demolished
Poor Start or Upper Wenson	Eastry	Isolated	Loose Courtyard	Nineteenth Century	Farmhouse/outfarm totally demolished
Blue Pigeons Farm	Worth	Isolated	Loose Courtyard	Nineteenth Century	Farmhouse/outfarm totally demolished
Willow Farm	Worth	Isolated	Loose Courtyard	Nineteenth Century	Farmhouse/outfarm totally demolished
Farmstead in Walmer	Walmer	Village	Loose Courtyard	Nineteenth Century	Farmhouse/outfarm totally demolished
Farmstead in Capel Street	Capel-le-Ferne	Isolated	Loose Courtyard	Nineteenth Century	Farmhouse/outfarm totally demolished
Fern Cottage	Capel-le-Ferne	Isolated	Loose Courtyard	Nineteenth Century	Farmhouse/outfarm totally demolished
Farmstead at Eythorne Green	Eythorne	Hamlet	Loose Courtyard	Nineteenth Century	Farmhouse/outfarm totally demolished

Name	Parish	Position	Form	Date	Condition
Farmstead in Ewell	Temple Ewell	Village	Loose Courtyard	Nineteenth Century	Farmhouse/outfarm totally demolished
Little America	Sutton	Isolated	Loose Courtyard	Nineteenth Century	Farmhouse/outfarm totally demolished
Hope Farm	St Margaret's at Cliffe	Isolated	Loose Courtyard	Nineteenth Century	Farmhouse/outfarm totally demolished
Street Fm	St Margaret's at Cliffe	Village	Loose Courtyard	Nineteenth Century	Farmhouse/outfarm totally demolished
Little Everden	Alkham	Isolated	L-Plan	Nineteenth Century	Farmhouse/outfarm totally demolished
Farmstead in Upper Eythorne	Eythorne	Village	Parallel	Nineteenth Century	Farmhouse/outfarm totally demolished
Old Park Farm	Aylesham	Isolated	Regular Courtyard	Nineteenth Century	Farmhouse/outfarm totally demolished
Farmstead W of St Mary	Sandwich	Isolated	Regular Courtyard	Nineteenth Century	Farmhouse/outfarm totally demolished
Parsonage Farm	Hougham Without	Isolated	Regular Courtyard	Nineteenth Century	Farmhouse/outfarm totally demolished
Farmstead SE of Hougham Lodge	Dover	Isolated	Regular Courtyard	Nineteenth Century	Farmhouse/outfarm totally demolished
Broad Lees Farm	Guston	Isolated	Regular Courtyard	Nineteenth Century	Farmhouse/outfarm totally demolished
Well Farm	Langdon	Farmstead Cluster	Regular Courtyard	Nineteenth Century	Farmhouse/outfarm totally demolished
Farmstead SE of Holly Farm	Deal	Village	Regular Courtyard	Nineteenth Century	Farmhouse/outfarm totally demolished
Ashwood Farm	Preston	Isolated	Regular Courtyard	Nineteenth Century	Farmhouse/outfarm totally demolished
Farmstead N of Upper Deal	Sholden	Isolated	Regular Courtyard	Nineteenth Century	Farmhouse/outfarm totally demolished
Courtledge Farm	Deal	Isolated	Regular Courtyard	Nineteenth Century	Farmhouse/outfarm totally demolished

Name	Parish	Position	Form	Date	Condition
Farmstead SE of Sandfield Farm	Deal	Isolated	Regular Courtyard	Nineteenth Century	Farmhouse/outfarm totally demolished
Farmstead in Walmer	Walmer	Village	Regular Courtyard	Nineteenth Century	Farmhouse/outfarm totally demolished
Farmstead SE of Drellingore Farm	Alkham	Isolated	Regular Courtyard	Nineteenth Century	Farmhouse/outfarm totally demolished
LyOak Farm	Lydden	Isolated	Regular Courtyard	Nineteenth Century	Farmhouse/outfarm totally demolished
Norton Farm	Alkham	Village	Regular Courtyard	Nineteenth Century	Farmhouse/outfarm totally demolished
Cold Blow	Lydden	Isolated	Regular Courtyard	Nineteenth Century	Farmhouse/outfarm totally demolished
Coombe Farm	Dover	Isolated	Regular Courtyard	Nineteenth Century	Farmhouse/outfarm totally demolished
Archer's Court	Whitfield	Isolated	Regular Courtyard	Nineteenth Century	Farmhouse/outfarm totally demolished
Farmstead adjacent to Elms Lane	Dover	Isolated	Regular Courtyard	Nineteenth Century	Farmhouse/outfarm totally demolished
Yard in St Margaret at Cliffe	St Margaret's at Cliffe	Village	Regular Courtyard	Nineteenth Century	Farmhouse/outfarm totally demolished
King's Barn	Ringwould with Kingsdown	Hamlet	Regular Courtyard	Nineteenth Century	Farmhouse/outfarm totally demolished
Brewer's Farm	Great Mongeham	Village	Uncertain	Eighteenth Century	Not Recorded

Name	Parish	Position	Form	Date	Condition
Outfarm W of Finglesham Granage	Northbourne	Isolated	Singular	Seventeenth Century	Extent (no apparent alteration)
Outfarm N of Stourmouth Farm	Stourmouth	Isolated	Loose Courtyard	Nineteenth Century	Extent (no apparent alteration)
Oast in Wingham	Wingham	Isolated	N/A	Nineteenth Century	Extent (no apparent alteration)
Yard SW of Little Farthingloe Farm	Dover	Isolated	Regular Courtyard	Nineteenth Century	Extent (no apparent alteration)
Outfarm W of Shatterling Court Farm	Staple	Hamlet	Singular	Nineteenth Century	Extent (no apparent alteration)
Outfarm S of Paramour Farm	Ash	Village	Singular	Nineteenth Century	Extent (no apparent alteration)
Outfarm NE of Hammill farm Cottages	Woodnesborough	Village	Singular	Nineteenth Century	Extent (no apparent alteration)
Outfarm in New Street	Woodnesborough	Village	Singular	Nineteenth Century	Extent (no apparent alteration)
Outfarm S of Lower Heronden Farm	Eastry	Village	Singular	Nineteenth Century	Extent (no apparent alteration)
Outfarm in Longlands Plantation	Northbourne	Isolated	Singular	Nineteenth Century	Extent (no apparent alteration)
Sheep pens on Minster Marsh	Ash	Farmstead Cluster	Singular	Nineteenth Century	Extent (no apparent alteration)
Outfarm E of Wootton	Denton with Wootton	Village	Singular	Nineteenth Century	Extent (no apparent alteration)
Outfarm NW of Castle View Farm	Hougham Without	Isolated	Singular	Nineteenth Century	Extent (no apparent alteration)
Outfarm SE of Newhouse Farm	Stourmouth	Isolated	Dispersed	Nineteenth Century	Partial loss (less than 50% change)
Outfarm SSW of Court Farm	Preston	Isolated	Loose Courtyard	Nineteenth Century	Partial loss (less than 50% change)
Townsend Farm	Northbourne	Isolated	Loose Courtyard	Nineteenth Century	Partial loss (less than 50% change)
Outfarm NE of Foulmead Farm	Sholden	Isolated	Loose Courtyard	Nineteenth Century	Partial loss (less than 50% change)
Yard in Satmar	Capel-le-Ferne	Isolated	Loose Courtyard	Nineteenth Century	Partial loss (less than 50% change)
Yard NW of Little Satmar Farm	Capel-le-Ferne	Isolated	Regular Courtyard	Nineteenth Century	Partial loss (less than 50% change)

Table 2 Outfarms in Dover District identified by the Kent Farmsteads Survey

Name	Parish	Position	Form	Date	Condition
New Barn Farm	Stourmouth	Isolated	Regular Courtyard	Uncertain	Partial loss (less than 50% change)
Yard NE of The Cottage	Goodnestone	Isolated	Regular Courtyard	Pre 1600	Significant loss (more than 50% change)
Yard S of Whitfield	Whitfield	Isolated	Loose Courtyard	Nineteenth Century	Significant loss (more than 50% change)
Yard in Staple	Staple	Village	Regular Courtyard	Nineteenth Century	Significant loss (more than 50% change)
Farmstead SW of Felderland Farm	Worth	Hamlet	Regular Courtyard	Nineteenth Century	Significant loss (more than 50% change)
Outfarm E of Little Statenborough Farm Cottage	Eastry	Isolated	Singular	Nineteenth Century	Significant loss (more than 50% change)
Outfarm E of Wootton	Denton with Wootton	Village	Singular	Nineteenth Century	Significant loss (more than 50% change)
Farmstead in Deal	Deal	Village	Regular Courtyard	Nineteenth Century	Farmhouse only survives
Little Westhill Farm	Alkham	Isolated	Dispersed	Nineteenth Century	Total change (complete alteration to plan)
Outfarm NE of Home Farm	Tilmanstone	Isolated	Dispersed	Nineteenth Century	Farmhouse/outfarm totally demolished
Outfarm on Stourmouth Valley	Stourmouth	Isolated	Loose Courtyard	Nineteenth Century	Farmhouse/outfarm totally demolished
Outfarm N of Church Cottage	Nonington	Church, Manor or other high status farmstead	Loose Courtyard	Nineteenth Century	Farmhouse/outfarm totally demolished
Outfarm SSE of Bellevue Cottages	Ash	Village	Loose Courtyard	Nineteenth Century	Farmhouse/outfarm totally demolished
Sheep pen	Ash	Village	Loose Courtyard	Nineteenth Century	Farmhouse/outfarm totally demolished
Outfarm W of Beacon Hill Farm	Woodnesborough	Farmstead Cluster	Loose Courtyard	Nineteenth Century	Farmhouse/outfarm totally demolished
Sheepwash on Ash Level	Ash	Isolated	Loose Courtyard	Nineteenth Century	Farmhouse/outfarm totally demolished
Outfarm on Ash Level	Ash	Isolated	Loose Courtyard	Nineteenth Century	Farmhouse/outfarm totally demolished
Outfarm on Ash Level	Ash	Isolated	Loose Courtyard	Nineteenth Century	Farmhouse/outfarm totally demolished
Sheep pen on Ash Level	Ash	Isolated	Loose Courtyard	Nineteenth Century	Farmhouse/outfarm totally demolished

Name	Parish	Position	Form	Date	Condition
Outfarm SW of Home Farm	Northbourne	Isolated	Loose Courtyard	Nineteenth Century	Farmhouse/outfarm totally demolished
Outfarm SW of St Mary	Sandwich	Isolated	Loose Courtyard	Nineteenth Century	Farmhouse/outfarm totally demolished
Outfarm in Sholden	Sholden	Parkland	Loose Courtyard	Nineteenth Century	Farmhouse/outfarm totally demolished
Outfarm SE of Hill House Farm	Denton with Wootton	Isolated	Loose Courtyard	Nineteenth Century	Farmhouse/outfarm totally demolished
Outfarm N of Lydden	Lydden	Village	Loose Courtyard	Nineteenth Century	Farmhouse/outfarm totally demolished
Outlands	Temple Ewell	Isolated	Loose Courtyard	Nineteenth Century	Farmhouse/outfarm totally demolished
Outfarm NW of Kingsdown	Ringwoud with Kingsdown	Village	Loose Courtyard	Nineteenth Century	Farmhouse/outfarm totally demolished
Outfarm E of Stourmouth House	Preston	Village	Loose Courtyard	Nineteenth Century	Farmhouse/outfarm totally demolished
Hop pickers huts NNE of Perry Farm	Preston	Isolated	N/A	Nineteenth Century	Farmhouse/outfarm totally demolished
Outfarm N of Trapham Farm	Wingham	Isolated	Regular Courtyard	Nineteenth Century	Farmhouse/outfarm totally demolished
Building group SE of Beaute Farm	Staple	Village	Regular Courtyard	Nineteenth Century	Farmhouse/outfarm totally demolished
New Barn	Wingham	Isolated	Regular Courtyard	Nineteenth Century	Farmhouse/outfarm totally demolished
Outfarm N of Poplar Farm	Sandwich	Village	Regular Courtyard	Nineteenth Century	Farmhouse/outfarm totally demolished
Outfarm W of Deal	Deal	Village	Regular Courtyard	Nineteenth Century	Farmhouse/outfarm totally demolished
Outfarm in Deal	Deal	Village	Regular Courtyard	Nineteenth Century	Farmhouse/outfarm totally demolished
Outfarm SW of Elms Vale	Dover	Isolated	Regular Courtyard	Nineteenth Century	Farmhouse/outfarm totally demolished
Outfarm N of Ackholt	Aylesham	Isolated	Singular	Nineteenth Century	Farmhouse/outfarm totally demolished
Outfarm SW of Dambridge Farm	Wingham	Isolated	Singular	Nineteenth Century	Farmhouse/outfarm totally demolished
Outfarm NW of Witherdens Hall	Wingham	Isolated	Singular	Nineteenth Century	Farmhouse/outfarm totally demolished

Name	Parish	Position	Form	Date	Condition
Outfarm NW of Preston	Preston	Isolated	Singular	Nineteenth Century	Farmhouse/outfarm totally demolished
Outfarm SW of Newhouse Farm	Stourmouth	Hamlet	Singular	Nineteenth Century	Farmhouse/outfarm totally demolished
Outfarm SW of Shatterling Court Farm	Staple	Isolated	Singular	Nineteenth Century	Farmhouse/outfarm totally demolished
Outfarm SW of Beaute Farm	Staple	Isolated	Singular	Nineteenth Century	Farmhouse/outfarm totally demolished
Outfarm S of Brook Farm	Wingham	Isolated	Singular	Nineteenth Century	Farmhouse/outfarm totally demolished
Outfarm S of Twitham Farm	Goodnestone	Isolated	Singular	Nineteenth Century	Farmhouse/outfarm totally demolished
Outfarm SW of Church Cottage	Nonington	Village	Singular	Nineteenth Century	Farmhouse/outfarm totally demolished
Outfarm N of Frogham Farm	Nonington	Isolated	Singular	Nineteenth Century	Farmhouse/outfarm totally demolished
Outfarm SE of Durlock	Ash	Isolated	Singular	Nineteenth Century	Farmhouse/outfarm totally demolished
Outfarm NNW of Spindle Farm	Ash	Isolated	Singular	Nineteenth Century	Farmhouse/outfarm totally demolished
Outfarm N of Spindle Farm	Ash	Isolated	Singular	Nineteenth Century	Farmhouse/outfarm totally demolished
Outfarm SSW of Cop Street Farm	Ash	Village	Singular	Nineteenth Century	Farmhouse/outfarm totally demolished
Outfarm in Ash	Ash	Isolated	Singular	Nineteenth Century	Farmhouse/outfarm totally demolished
Sheep pen	Ash	Village	Singular	Nineteenth Century	Farmhouse/outfarm totally demolished
Outfarm in New Street	Ash	Village	Singular	Nineteenth Century	Farmhouse/outfarm totally demolished
Outfarm NE of Ringleton Manor	Woodnesborough	Village	Singular	Nineteenth Century	Farmhouse/outfarm totally demolished
Outfarm in Tilmanstone	Tilmanstone	Isolated	Singular	Nineteenth Century	Farmhouse/outfarm totally demolished
Outfarm SW of Beacon Hill Farm	Woodnesborough	Farmstead Cluster	Singular	Nineteenth Century	Farmhouse/outfarm totally demolished
Outfarm W of Brooke Street farmhouse	Ash	Farmstead Cluster	Singular	Nineteenth Century	Farmhouse/outfarm totally demolished

Name	Parish	Position	Form	Date	Condition
Sheep pen	Ash	Isolated	Singular	Nineteenth Century	Farmhouse/outfarm totally demolished
Outfarm on Ash Level	Ash	Isolated	Singular	Nineteenth Century	Farmhouse/outfarm totally demolished
Sheep pens NNE of Red Lion Inn	Sandwich	Isolated	Singular	Nineteenth Century	Farmhouse/outfarm totally demolished
Outfarm NE of Finglesham	Northbourne	Isolated	Singular	Nineteenth Century	Farmhouse/outfarm totally demolished
Sheep fold on Worth Minnis	Worth	Isolated	Singular	Nineteenth Century	Farmhouse/outfarm totally demolished
Outfarm SE of Hillside Farm	Great Mongeham	Isolated	Singular	Nineteenth Century	Farmhouse/outfarm totally demolished
Outfarm NE of Church Farm	Deal	Village	Singular	Nineteenth Century	Farmhouse/outfarm totally demolished
Outfarm E of Great Mongeham	Deal	Village	Singular	Nineteenth Century	Farmhouse/outfarm totally demolished
Pound NE of Worth	Worth	Village	Singular	Nineteenth Century	Farmhouse/outfarm totally demolished
Outfarm W of Redhouse Farm	Sholden	Village	Singular	Nineteenth Century	Farmhouse/outfarm totally demolished
Outfarm NE of Sandfield Farm	Deal	Village	Singular	Nineteenth Century	Farmhouse/outfarm totally demolished
Outfarm SE of Sandfield Farm	Deal	Isolated	Singular	Nineteenth Century	Farmhouse/outfarm totally demolished
Outfarm NW of Dairy Farm	Denton with Wootton	Village	Singular	Nineteenth Century	Farmhouse/outfarm totally demolished
Outfarm SW of Shelvin Grove	Denton with Wootton	Isolated	Singular	Nineteenth Century	Farmhouse/outfarm totally demolished
Outfarm SW of Parkside Farm	Denton with Wootton	Village	Singular	Nineteenth Century	Farmhouse/outfarm totally demolished
Outfarm NE of Frandham Farm	River	Isolated	Singular	Nineteenth Century	Farmhouse/outfarm totally demolished
Outfarm SE of Sun Valley Farm	Temple Ewell	Isolated	Singular	Nineteenth Century	Farmhouse/outfarm totally demolished
Outfarm adjacent to Elm Farm House	Whitfield	Isolated	Singular	Nineteenth Century	Farmhouse/outfarm totally demolished
Outfarm E of Whitfield	Whitfield	Village	Singular	Nineteenth Century	Farmhouse/outfarm totally demolished

Name	Parish	Position	Form	Date	Condition
Abbot's Barn	Ringwould with Kingsdown	Village	Singular	Nineteenth Century	Farmhouse/outfarm totally demolished
Outfarm NW of Walton	Eastry	Isolated	Singular	Nineteenth Century	Farmhouse/outfarm totally demolished
Outfarm NW of Home Farm	Northbourne	Isolated	Singular	Nineteenth Century	Farmhouse/outfarm totally demolished