



WELCOME

Introduction

Guildhall Market Square

Previous consultations as part of the New Vision for Sandwich identified the Guildhall and Square as a focal point of the town and the first target for a major regeneration project.

Proposals for the Market Square have been developed on behalf of Dover District Council in association with the Board of A New Vision for Sandwich - Sandwich Town Council, the Town Team, Kent County Council, Historic England, Sandwich Chamber of Commerce and Discovery Park.

The primary focus of this proposal is the Square itself, but careful consideration has been given to its connection to adjacent streets and the rest of the Town as part of the wider vision for future of Sandwich.

The designs shown are the first phase of a detailed design process working toward a planning application for the Square and a bid to the Coastal Communities Fund for money to deliver the project.

Feedback from the Public, Stakeholders and others will inform a revised proposal to be submitted for planning approval in 2018, with the aim of completing works to the Square in time for the return of The Open to Royal St George's in 2020.

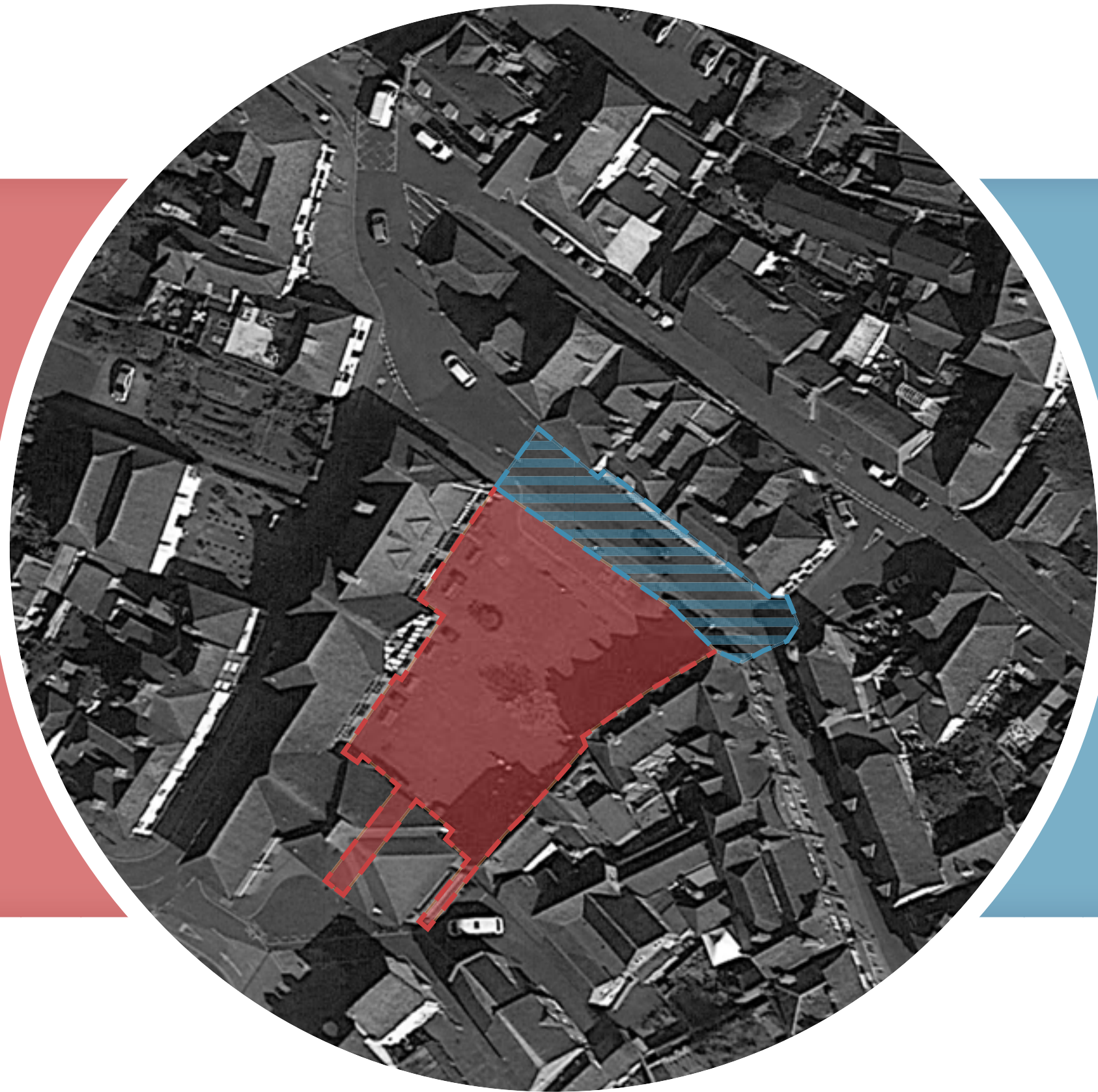

Cattle Market & Bus Stops

Changes to the road layout and bus stops on Cattle Market are being designed in collaboration with Kent County Council Highways.

The designs shown are an initial concept scheme which will be examined in further detail by KCC, Stagecoach and others to ensure pedestrian safety, traffic flow and maintainability criteria are met.

These suggestions form part of a wider series of Highways works separate from the Guildhall Project and the Square.

Design Drivers

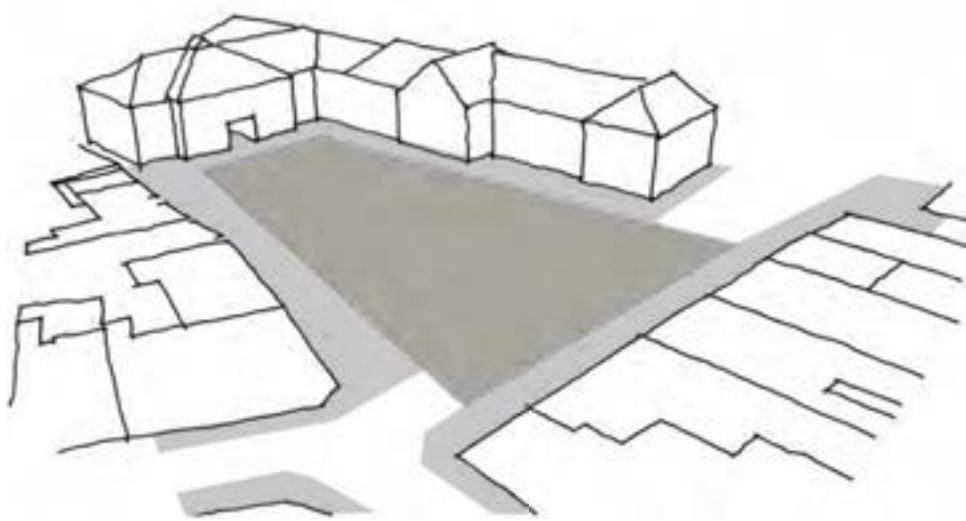

Flexible Space

Provide an open central plaza for events, markets, etc., continuing the historic use of the site.

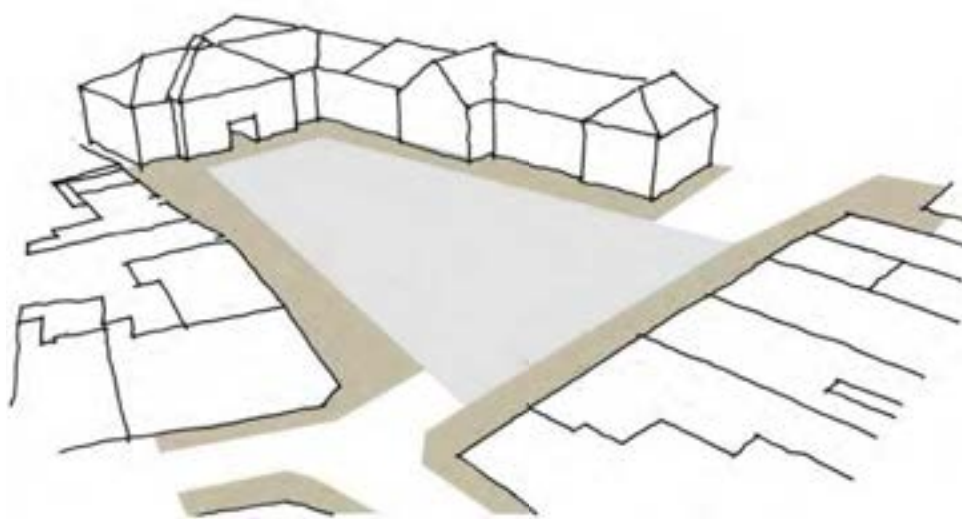

Building Margin

York Stone paving as a plinth or 'skirt' to buildings, as seen throughout Sandwich.

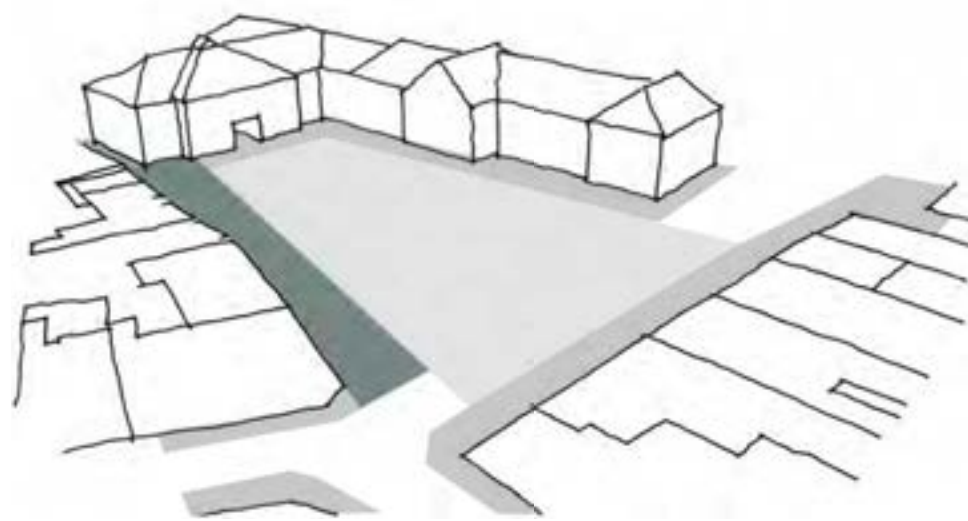

Historic Street Pattern

Preserving & highlighting the Ancient Highway, urban repair and continuity.

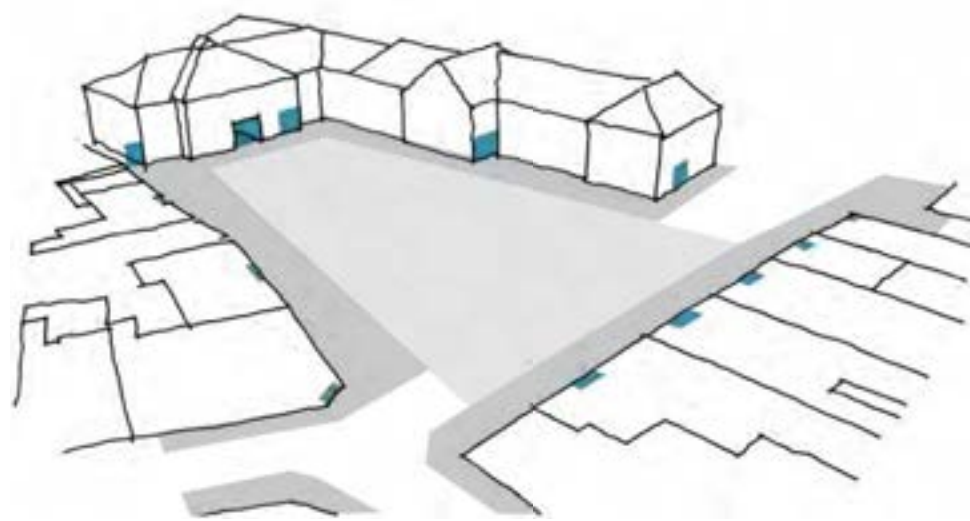

Entrances

Maintaining open access to retail frontages, reinforcing the entrances to the Guildhall, Museum and Tourist Information Centre.

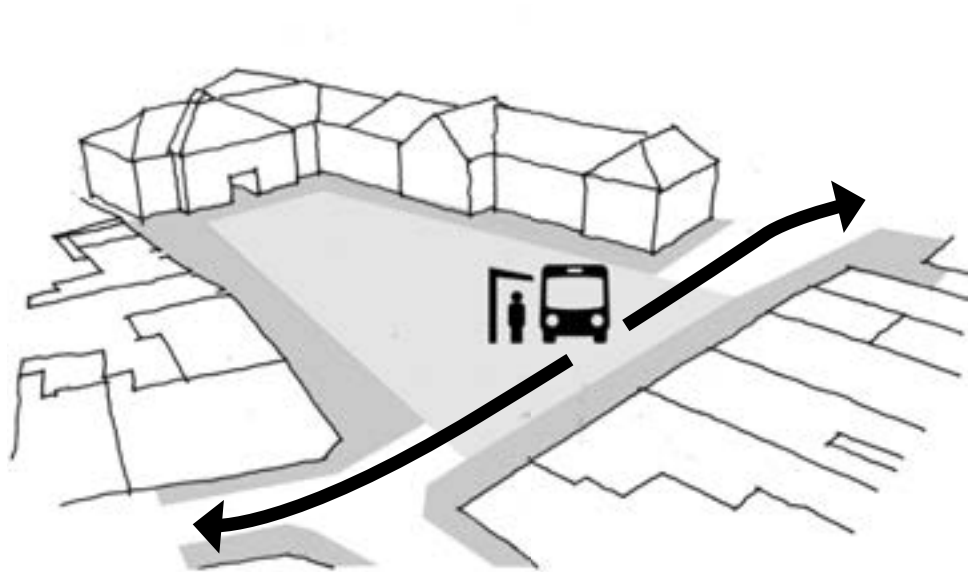

Bus Route & Stops

Accommodating bus and general traffic movements along the edge of the Square, improved bus stop and shelter, and creating an 'arrival point' for visitors to the Town.

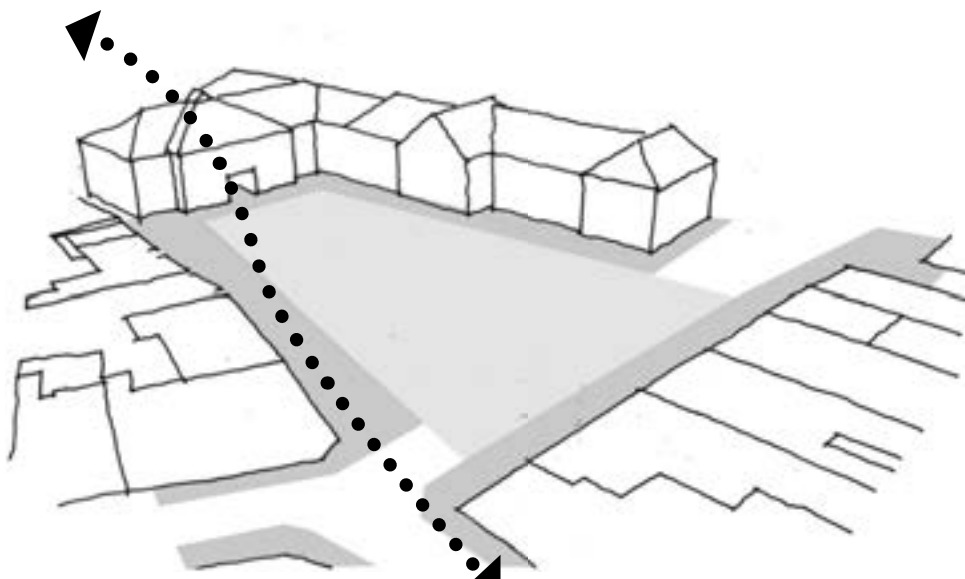

Link to Town & Quay

Highlight and provide a waypoint on the key pedestrian route through the town, connecting the Square, Market Street and the Quay.

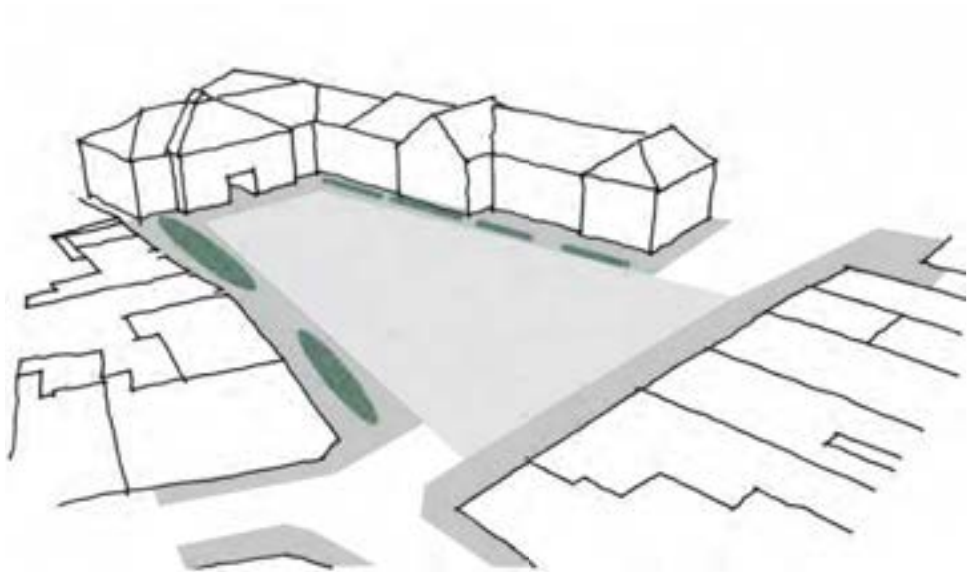

Seating

Provide a variety of seating suitable for all, including fixed and flexible seating



PROPOSALS

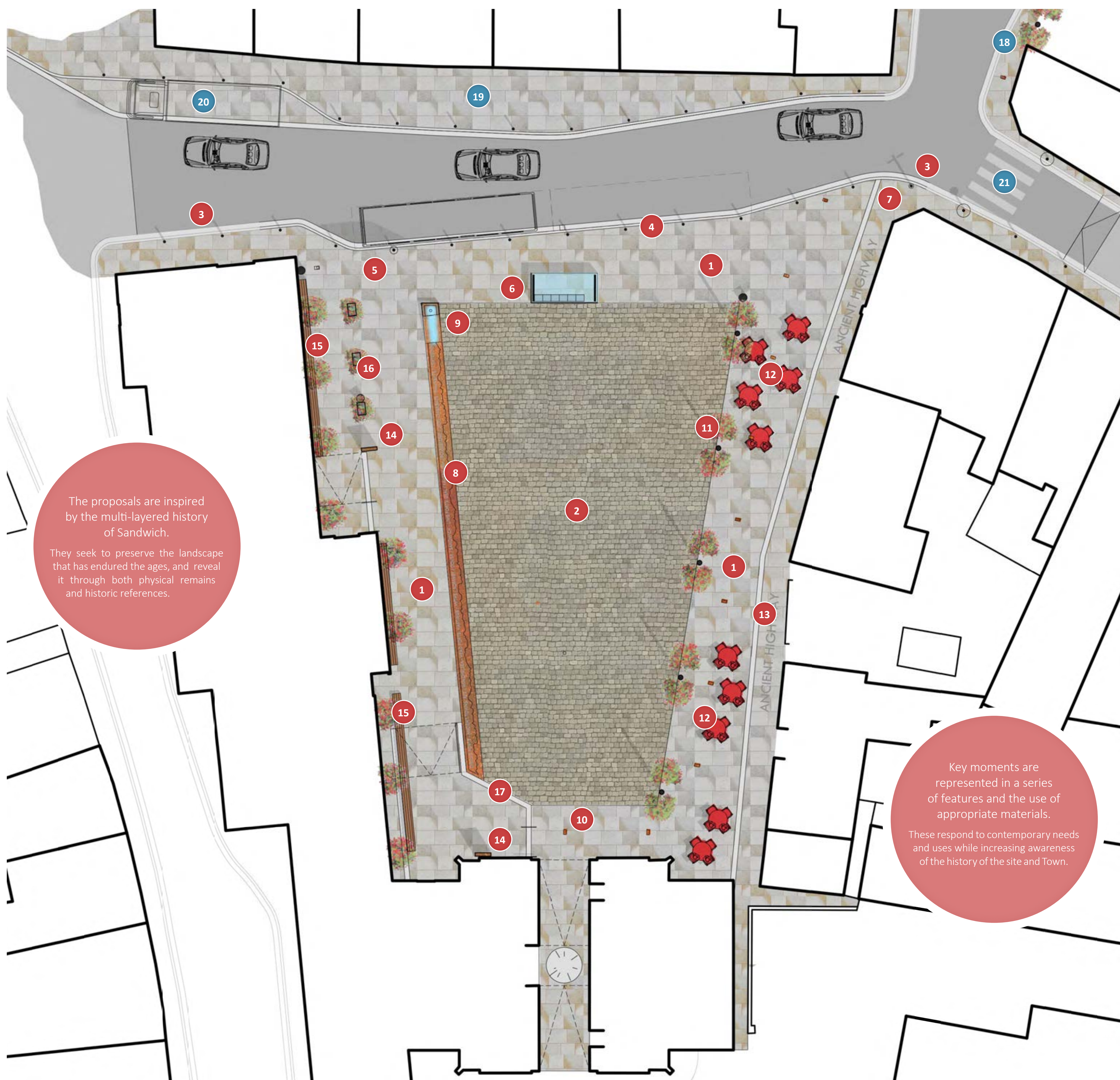

1. Large unit York Stone flag paving along building perimeters, continuing the existing historic style.
2. Main square & area for markets and events in small unit temple setts, laid flush to provide an accessible surface suitable for all but retain the character of the existing rough cobbles.
3. Granite kerbs and verge channel to edge of carriageways, continuing the existing historic style.
4. Bollards protect & delineate carriageway and bus stop from Square, with drop-down bollard giving vehicle access when needed.
5. Bus stop with standard timetable pole & upstand kerb for level access.
6. Illuminated glass bus shelter engraved with imagery and/or text, reinforcing the history of the Town.

7. Existing traditional finger post sign refurbished and relocated.
8. Weathered steel grating inset with text and/or images referencing aspects of local history, illuminated from below and providing improved surface water drainage.
9. Drinking fountain as continuation of the grating, making reference to the Delf stream's past as the town's only water source.
10. 'Stepping Stones' with emblem highlighting route from Square to Quay and other key locations in the Town.
11. Contemporary pole lights to provide evening illumination and emphasise former street pattern, with opportunities for banner arms, hanging baskets, bunting etc. for festivals and events.

12. Spill-out café seating area with uniform table & chair sets in town colour(s).
13. Ancient highway marked by granite channel and engraved text in flag paving.
14. New 'totem' sign boards to Museum & proposed Tourist Information Centre entrances.
15. Linear benches adjacent to Guildhall, illuminated from below.
16. Planters marking outline of former Guildhall border, with Dutch bulbs and engraved imagery/text making reference to the arrival of Protestant refugees and their influence on the history of the town.
17. Raised area provides level access to Tourist Information Centre and acts as informal stage for events.

18. Future phase could see pole lights and 'stepping stones' carried through No Name Street and Market Street to guide pedestrians toward the Quay (subject to further consultation and KCC Highways detail design).
19. Relocated bus stop would allow road realignment and widening of northern footpath, potentially providing spill-out space for restaurants (subject to further consultation and KCC Highways detail design).
20. Road realignment could include provision of off-street restricted loading bay, with existing taxi ranks relocated (subject to further consultation and KCC Highways detail design).
21. Existing pedestrian crossing on New Street retained & widened where possible.

PROPOSALS



The interventions are subtle so as not to compete with the strong architectural backdrop. Instead they create interactive and playful features that reveal historical moments and attract people to the site, reinforcing its primary use as a place to meet and socialise.

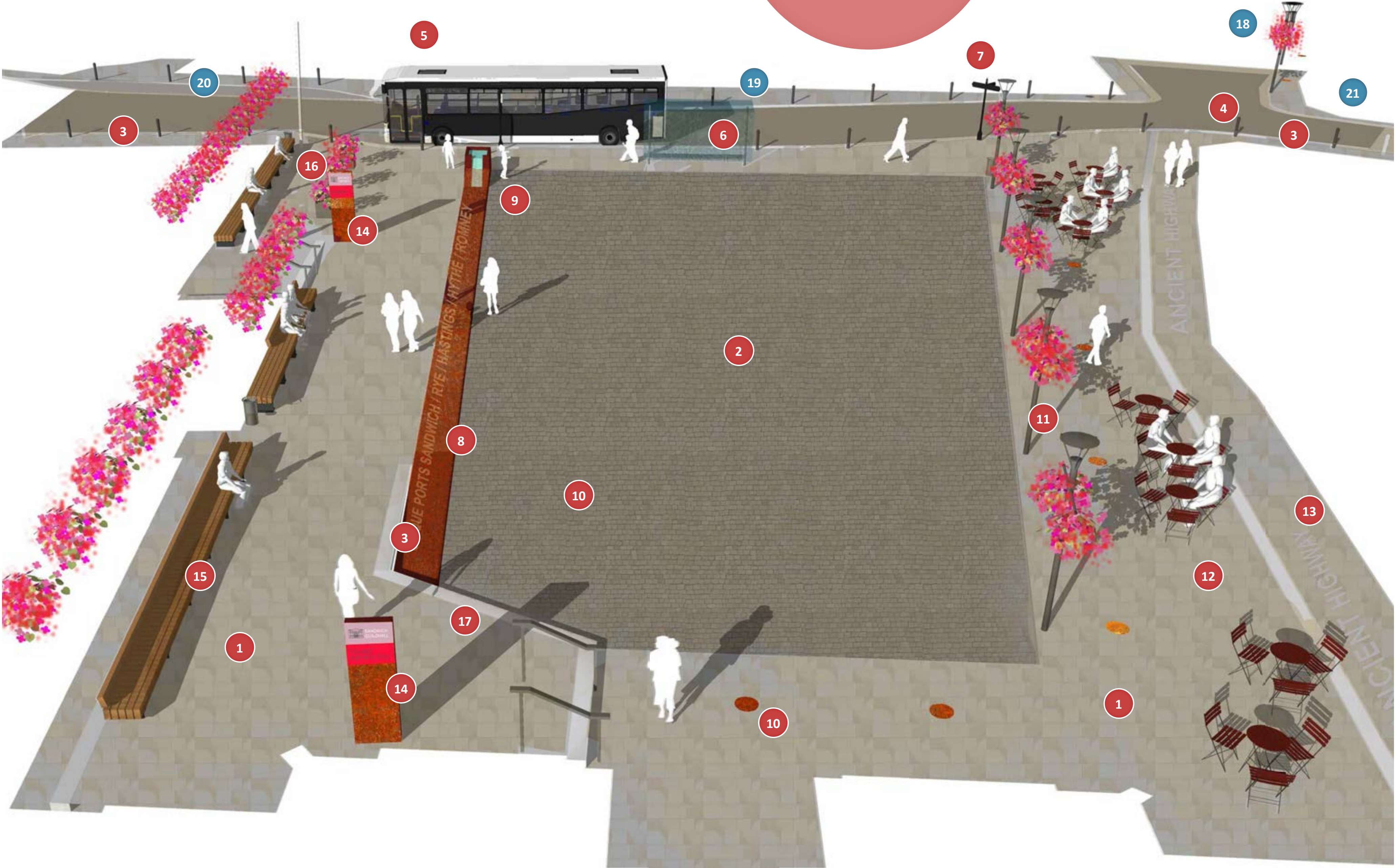

'Strangers'

French and Flemish Protestant refugees flee religious intolerance, bringing new trades, skills and ideas to the town.



Battle of Sandwich

French ships attempting to bring aid to an invasion force and English rebels were defeated by the fleet, securing Henry III's reign.



The Cinque Ports

Privileges and benefits were granted to Sandwich as one of the major ports on the south coast, in return for providing ships to serve the Crown in time of need.



The Delf Stream

Passing close by, but now almost entirely hidden from view, the Delf was once the only fresh water supply for the whole town and critical to its health and vitality.



Cattle Market

The area surrounding the Guildhall once held the extensive livestock markets, a key part of the Town and port economy.

Existing Palette



York Stone Flags

The majority of Sandwich is paved with large York Stone slabs which form a plinth or 'skirt' to the historic buildings.



Aged Granite Kerbs

Pavements throughout the town are edged with worn granite kerbs and a flat drainage channel.



Old Tarmac

The perimeter of the Square has an infill of plain tarmac unsympathetic to the adjacent buildings and cobbles.



Granite Cobbles

The existing cobbles are reclaimed from a mix of sources, roughly laid with wide joints giving an uneven surface unsuitable for some users.



Brick Pavers

In some areas of the town the pavement and/or road surface have been replaced with modern block paving.

Proposed



York Stone Flags

Reclaimed & aged paving stones to match style and colour of the existing, reinstating the town's unique character throughout.



Sawn Granite Kerbs

New crisply finished kerbs & channels to replicate the existing style but with a fresh look.



Weathered Steel

Used for new signage and sculptural features, with an aged appearance appropriate to the context.



Temple Setts

Similar in appearance to old granite cobbles, a warm colour mix to complement the Guildhall with tighter joints and a smoother top surface suitable for all.



Dutch Clay Pavers

Used on roads and pavements as an alternative surface sympathetic to the local character where stone or setts are impractical.



Don't Worry!
The existing cobbles will be removed, cleaned and kept for re-use elsewhere in Sandwich as future phases progress.

Materials are selected from the existing palette of the town
Accompanied by furniture and fittings based on styles, materials, and colours that respect, reflect, and will ultimately reinforce the site's heritage status.



Bus Shelter

Minimal glass and black steel design, visually unobtrusive.
Glass etched with historical imagery, old photographs, maps and/or visitor information.

Linear Benches

Chunky timber and black steel, referencing the surrounding half-timbered buildings.
Mix of seating, single or double sided, with and without backrests.

Black Steel Fittings

Bollards, drain covers, etc. in gloss black modelled on historic examples.

Cast Iron Signage

Existing finger posts and other heritage features retained where possible.

Guildhall Signage

Vertical sectional ‘totems’ in weathered and/or painted steel.
To highlight Guildhall, Museum and Tourist Information Centre entrances to visitors.

Café Tables & Chairs

Minimal steel fold-away temporary furniture for adjacent retailers.
Colours to match Town Council/Museum red and blue colour scheme.

Lanterns

Contemporary lighting columns based on traditional lantern type.
Can be fitted with banner arms for signage/advertising or hanging baskets.

Emblem/Logo

All fittings and furniture where possible can include a subtle embossed or laser-cut emblem.
This could be based on the ‘Battle of Sandwich’ logo, or the ‘Sandwich Rose’ compass design.



THANK YOU



Thank You for Taking Part

Please fill out our online feedback form at the
address below:

www.surveymonkey.co.uk/r/VSDGYWM

We want to hear what you think - your opinions are
important, and will help to develop the design submitted
for Planning Permission later in the Spring.

**MARK
HANTON
STUDIO.**

HMY

Mark Hanton Studio are an award-winning landscape architecture and urban design practice based near Ashford, and have previously worked on schemes throughout London and the South East, including the hugely successful Harbour Square in Folkestone.

www.markhantonstudio.co.uk

Hazle McCormack Young are Chartered Architects based in Canterbury and Tunbridge Wells with extensive experience of public sector and heritage projects, including the regeneration of the Pantiles in Tunbridge Wells and Dover's Georgian seafront.

www.hmy.uk.com



For updates on the project, and A New Vision for
Sandwich, please sign up to the 'Sandwich' Topic
on Keep Me Posted from Dover District Council:

www.dover.gov.uk/keepmeposted



**SANDWICH
TOWN TEAM**

**DISCOVERY
PARK**

**SANDWICH
TOWN
COUNCIL**

**COASTAL
COMMUNITIES
TEAM**
DEAL & SANDWICH

Working together with
Historic England

**Kent
County
Council**

**DOVER
DISTRICT
COUNCIL**