



DOCUMENTS ON DEPOSIT

**These documents should remain
available for public inspection until
Monday 27th July, 2020.**

<p>THE KENT COUNTY COUNCIL (VARIOUS ROADS, DOVER DISTRICT) (WAITING RESTRICTIONS AND STREET PARKING PLACES) (No. 74) ORDER 2020</p>
--

**Proposed changes and additions to On-
Street Parking Orders**

**Council Offices,
White Cliffs Business Park,
Dover,
Kent CT16 3PJ**

In the District of Dover

THE KENT COUNTY COUNCIL (VARIOUS ROADS, DOVER DISTRICT) (WAITING RESTRICTIONS AND STREET PARKING PLACES) (No. 74) ORDER 2020

Notice is hereby given that KENT COUNTY COUNCIL intend to make the above Order under sections 1(1), 2(1) to (3), 3(2), 4(1) and (2), 32(1), 35(1), 45, 46, 49 and 53 of the Road Traffic Regulation Act 1984, and of all other enabling powers, and after consultation with the chief officer of police in accordance with Part III of Schedule 9 to the Act:

If made the effect of the Order will be to further amend Kent County Council (Various Roads, Dover District) (Waiting Restrictions and Street Parking Places) Order 2005 as follows :

**DOVER, DEAL and SANDWICH
PAY and DISPLAY PARKING**

It is proposed to alter the charging times for Pay and Display Parking to 9.00am – 6.00pm (currently it operates 9am – 5 pm) in all paid parking places in the District.

**WALMER
PROHIBITION OF WAITING – MOTOR CARAVANS**

It is proposed to prohibit motor caravans from waiting/parking between 6pm and 6am on all days in those parts of Kingsdown Road (north of the junction with Granville Road), The Beach and The Strand (south of a point in line with the boundary of 6/7 The Strand) where waiting is not currently prohibited at all times by double yellow lines.

**RIVER
PROHIBITION OF WAITING – ALL VEHICLES**

It is proposed to prohibit waiting by vehicles of all classes at all times (double yellow lines) as follows –

ALKHAM ROAD – on both sides from the speed limit signs near Abbey Road to a point 120 metres east of Lower Road (Temple Ewell); and

LOWER ROAD RIVER – (a) on the generally eastern and northern sides from a point 4 metres south of the boundary of 144/146 Lower Road (River) to a point in line with the boundary of 136/138; and (b) on the generally western and southern sides from that same point 4 metres south of the boundary of 144/146 Lower Road (River) to link up with the existing restriction at the junction with Minnis Road.

Full details are contained in the draft Order which, together with a copy of any orders which will be amended by the proposed Order, and a statement of the Council's reasons for proposing to make the Order may be examined at The Council Offices, White Cliffs Business Park, Dover.

Information relating to the proposals will be available from Friday 3 July 2020 on the Dover District Council web site - www.dover.gov.uk/parking.

If you have any questions concerning either of the proposed Order or require further information please contact the Parking Operations Manager, Council Offices, Honeywood Close, White Cliffs Business Park, Dover, Kent CT16 3PJ (01304 872422) during normal office hours.

If you wish to object to the proposed Order you should send the grounds for your objection in writing to the Parking Operations Manager, Council Offices, Honeywood Close, White Cliffs Business Park, Dover, Kent CT16 3PJ or by e-mail to parking.operations@dover.gov.uk by 12 noon on Monday 27th July, 2020.

This Notice is published by Dover District Council on behalf of Kent County Council Highways and Transportation, County Hall, Maidstone, ME14 (part of Kent County Council).

THE KENT COUNTY COUNCIL
(VARIOUS ROADS, DOVER DISTRICT) (WAITING RESTRICTIONS AND STREET
PARKING PLACES) (AMENDMENT No. 74) ORDER 2020

The Kent County Council, in exercise of its powers under sections 1(1), 2(1) to (3), 3(2), 4(1) and (2), 32(1), 35(1), 45, 46, 49, 53 and 124 of the Road Traffic Regulation Act 1984 ('the Act') and of all other enabling powers, and after consultation with the chief officer of police in accordance with Part III of Schedule 9 to the Act, hereby make the following Order:-

A. The Kent County Council (Various Roads, Dover District) (Waiting Restrictions and Street Parking Places) Order 2005 ('the Order') shall have effect as though:

In the Articles of the Order

PART J

In column 5 of the Table to Article 83 the wording of the "Chargeable Hours" to be amended to read "9.00am to 6.00pm" wherever it occurs.

In the Schedules to the Order

The following shall be inserted in Part B of the Order as Article 9A –

9A SAVE as provided in Part H of this Order no person shall, except upon the directions of or with the permission of a police constable in uniform or of a Civil Enforcement Officer, cause or permit any motor caravan to wait between the hours of 6pm and 6am in any road specified in the table

1	2	3
Item	Name of Road	Specified length
1	Kingsdown Road, Walmer	On both sides from the junction with Alexandra Road to the junction with Granville Road
2	The Beach, Walmer	On the eastern side from Kingsdown Road to The Strand
3	The Strand, Walmer	On the eastern side from The Beach to a point in line with the boundary of 6/7 The Strand

Schedules 5.00; 5.20; 5.30; 5.41 and 5.50

In the heading to each Schedule the wording of the "Chargeable Hours" to be amended to read "9.00am to 6.00pm" wherever it occurs.

Schedule 1 - NO WAITING AT ANY TIME

Roads in River in the District of Dover

ALKHAM ROAD

The item in the First Schedule relating to Alkham Road, River, to be deleted and replaced with:-
"On both sides from a point 120 metres east of the junction with Lower Road (Temple Ewell) to a point 305 metres south-west of the junction with Abbey Road."

LOWER ROAD, RIVER

The item in the First Schedule relating to Lower Road, River, to be deleted and replaced with:-

- (1) On both sides
 - (a) from a point in line with the boundary of 54/56 Lower Road eastwards to a point in line with the north-west wall of Royal Oak Public House;
 - (b) from a point opposite and in line with the boundary of 109/111 Lower Road to a point opposite and in line with the western building line of 70 Lower Road.
- (2) On the south-western and north-western sides from a point 3.5 metres north-west of the south-eastern building line of 177 Lower Road to a point 4 metres south-west of the boundary of 144/146 Lower Road.
- (3) On the north-eastern and south-eastern sides
 - (a) from a point in line with the western boundary of 102 Lower Road for a distance of 70 metres in a westerly direction;
 - (b) from a point in line with the boundary of 136/138 Lower Road to a point 4 metres south-west of the boundary of 144/146 Lower Road.

This Order may be cited as Kent County Council (Various Roads, Dover District) (Waiting Restrictions and Street Parking Places) (No. 74) Order 2020 and shall come into force on the XXX day of XXXXX, 2020.

Given under the Seal of the Kent County Council

This day of XXXX, 2020

THE COMMON SEAL OF THE
KENT COUNTY COUNCIL

was hereunto affixed in the
presence of:-

Authorised Signatory



Statement of Reasons

THE KENT COUNTY COUNCIL (VARIOUS ROADS, DOVER DISTRICT)
(WAITING RESTRICTIONS AND STREET PARKING PLACES)
(No. 74) ORDER 2020

The Kent County Council propose to make the above named Order

- (a) to prohibit waiting where it is appropriate to do so for avoiding danger to pedestrian and to facilitate the passage vehicular traffic;
- (b) to better balance parking demand with the availability of parking spaces;
- (c) for preventing the use of roads by vehicular traffic in a manner which is unsuitable.

1st July, 2020

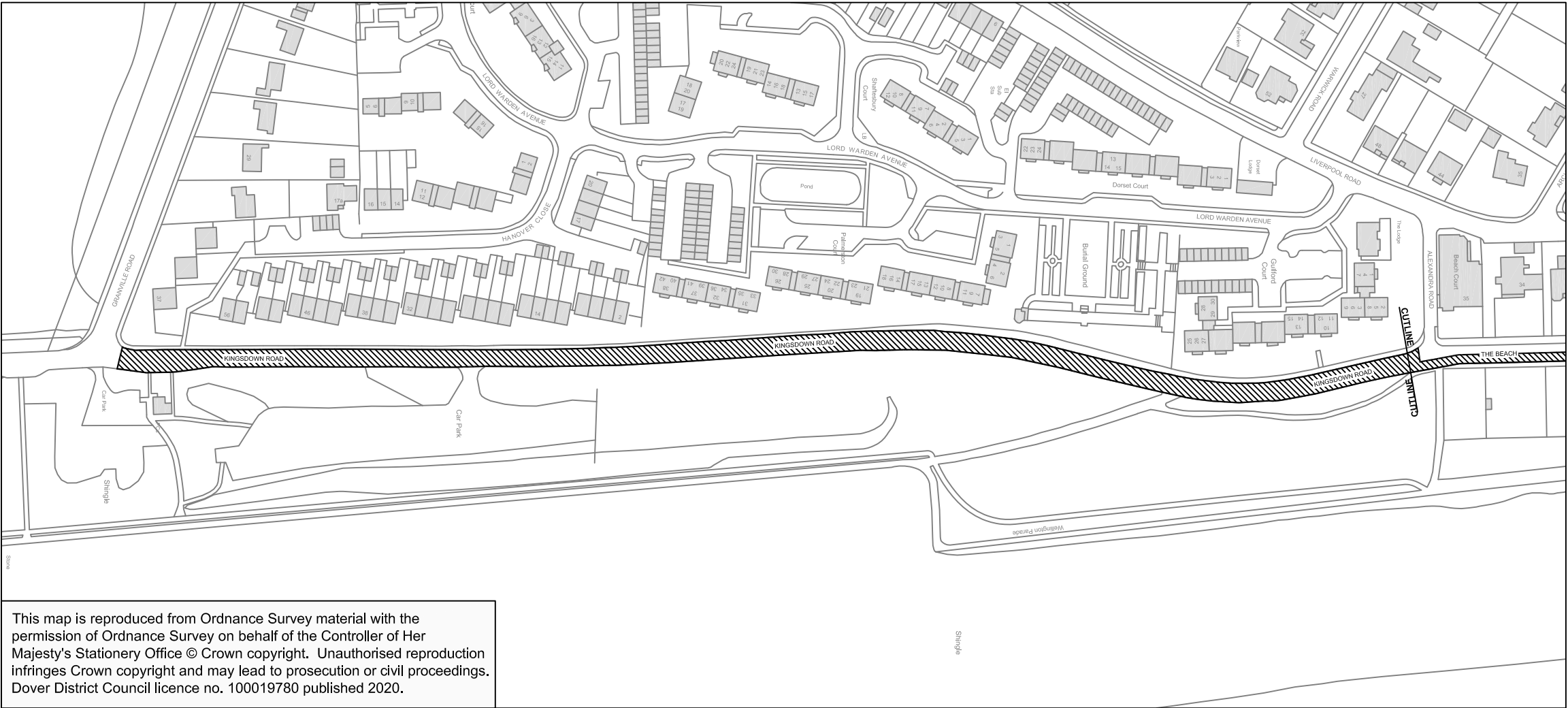
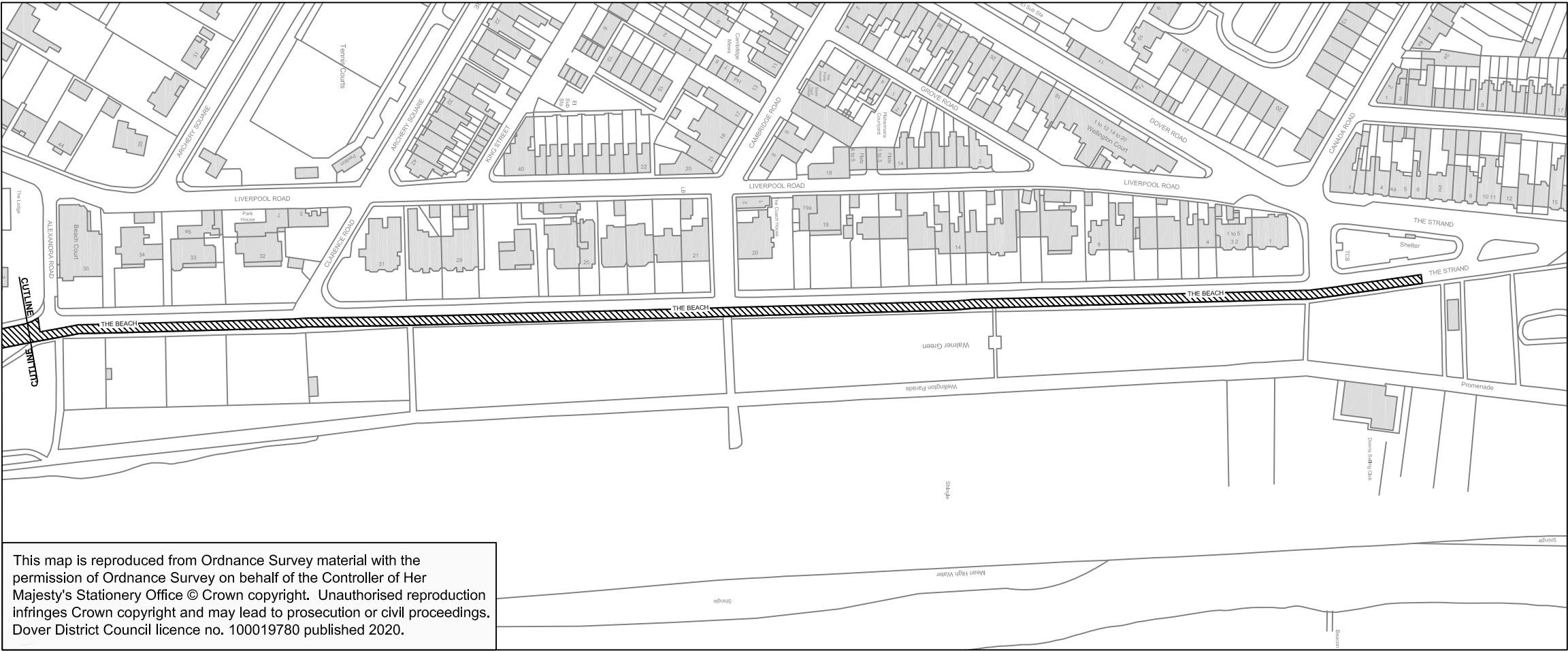

Key to Map

- Extent of proposed overnight parking restriction (as detailed on sign below):
- 1. The Beach** (eastern side)
 - 2. Kingsdown Road** (both sides)



Intermediate signs at 30 metre spacing (nominal)

Signs at respective ends of restriction



NOTE. Western side of **The Beach** is covered by existing double yellow line (No waiting at any time) prohibition



Prepared by
Parking Services
Dover District Council
Honeywood Close
White Cliffs Business Park
Dover CT16 3PJ
Tel: (01304) 821199

Euring **Roger Walton**, C.Eng, M.I.C.E.
STRATEGIC DIRECTOR (OPERATIONS & COMMERCIAL)

Scheme
Proposed Overnight Motor Caravan Parking Prohibition

Location
The Beach and Kingsdown Road (part of), Walmer Seafront

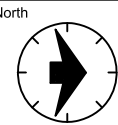

Designed: GEM Drawn: GEM Date: 17 June 2020

Scale
1 in 2000 (A3 size)

Drawing Number
TRAN/2020/0006

Rev
C

This map is reproduced from Ordnance Survey material with the permission of Ordnance Survey on behalf of the Controller of Her Majesty's Stationery Office © Crown copyright. Unauthorised reproduction infringes Crown copyright and may lead to prosecution or civil proceedings. Dover District Council licence no. 100019780 published 2020.

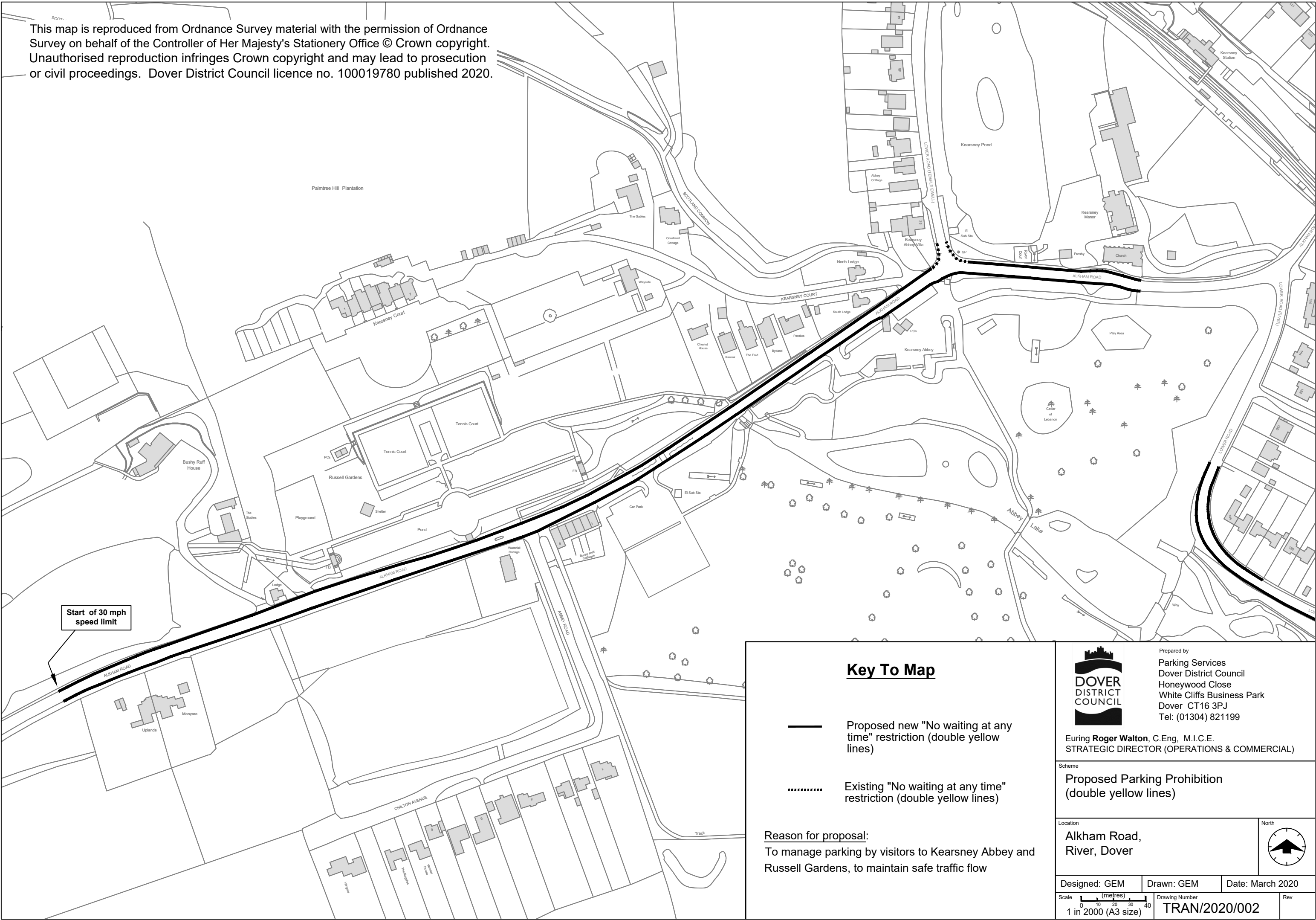

Key To Map

- Proposed new "No waiting at any time" restriction (double yellow lines)
- Existing "No waiting at any time" restriction (double yellow lines)

Reason for proposal:
To manage parking by visitors to Kearsney Abbey and Russell Gardens, to maintain safe traffic flow



Prepared by
Parking Services
Dover District Council
Honeywood Close
White Cliffs Business Park
Dover CT16 3PJ
Tel: (01304) 821199

Euring **Roger Walton**, C.Eng, M.I.C.E.
STRATEGIC DIRECTOR (OPERATIONS & COMMERCIAL)

Scheme
Proposed Parking Prohibition
(double yellow lines)

Location
Alkham Road,
River, Dover



Designed: GEM	Drawn: GEM	Date: March 2020
Scale 0 10 20 30 40 1 in 2000 (A3 size)	Drawing Number TRAN/2020/002	Rev

This map is reproduced from Ordnance Survey material with the permission of Ordnance Survey on behalf of the Controller of Her Majesty's Stationery Office © Crown copyright. Unauthorised reproduction infringes Crown copyright and may lead to prosecution or civil proceedings. Dover District Council licence no. 100019780 published 2020.

Key To Map

- Proposed new "No waiting at any time" restriction (double yellow lines)
- Existing "No waiting at any time" restriction (double yellow lines)

Reason for proposal:
To manage parking by visitors to Kearsney Abbey grounds. To maintain access and traffic flow.



Prepared by
Parking Services
Dover District Council
Honeywood Close
White Cliffs Business Park
Dover CT16 3PJ
Tel: (01304) 821199

Euring **Roger Walton**, C.Eng, M.I.C.E.
STRATEGIC DIRECTOR (OPERATIONS & COMMERCIAL)

Scheme
Proposed Parking Prohibition
(double yellow lines)

Location
Lower Rd (River) and Chilton Way,
River, Dover



Designed: GEM	Drawn: GEM	Date: March 2020
Scale 0 5 10 15 20 1 in 1000 (A3 size)	Drawing Number TRAN/2020/001	Rev A